

SOCE036 Installation Instruction

Please be sure to use a manual screwdriver and refrain from using an electric drill.





All panels and accessories



All panels and accessories

Because the sizes are different,
the lengths of the small board and the top board are
also different. The actual size shall prevail.

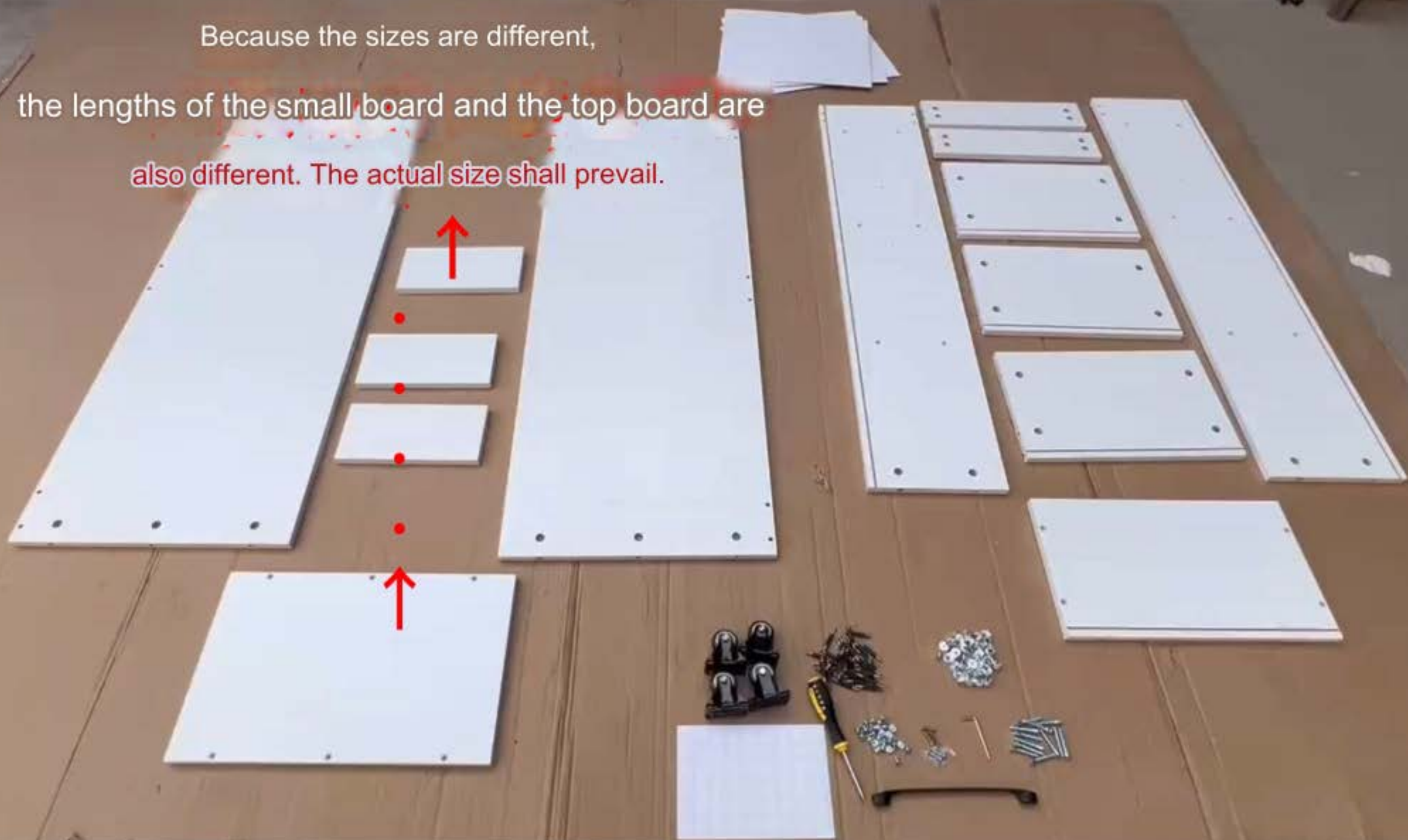



First, tighten the black screws on all the white embedded parts on the boards.

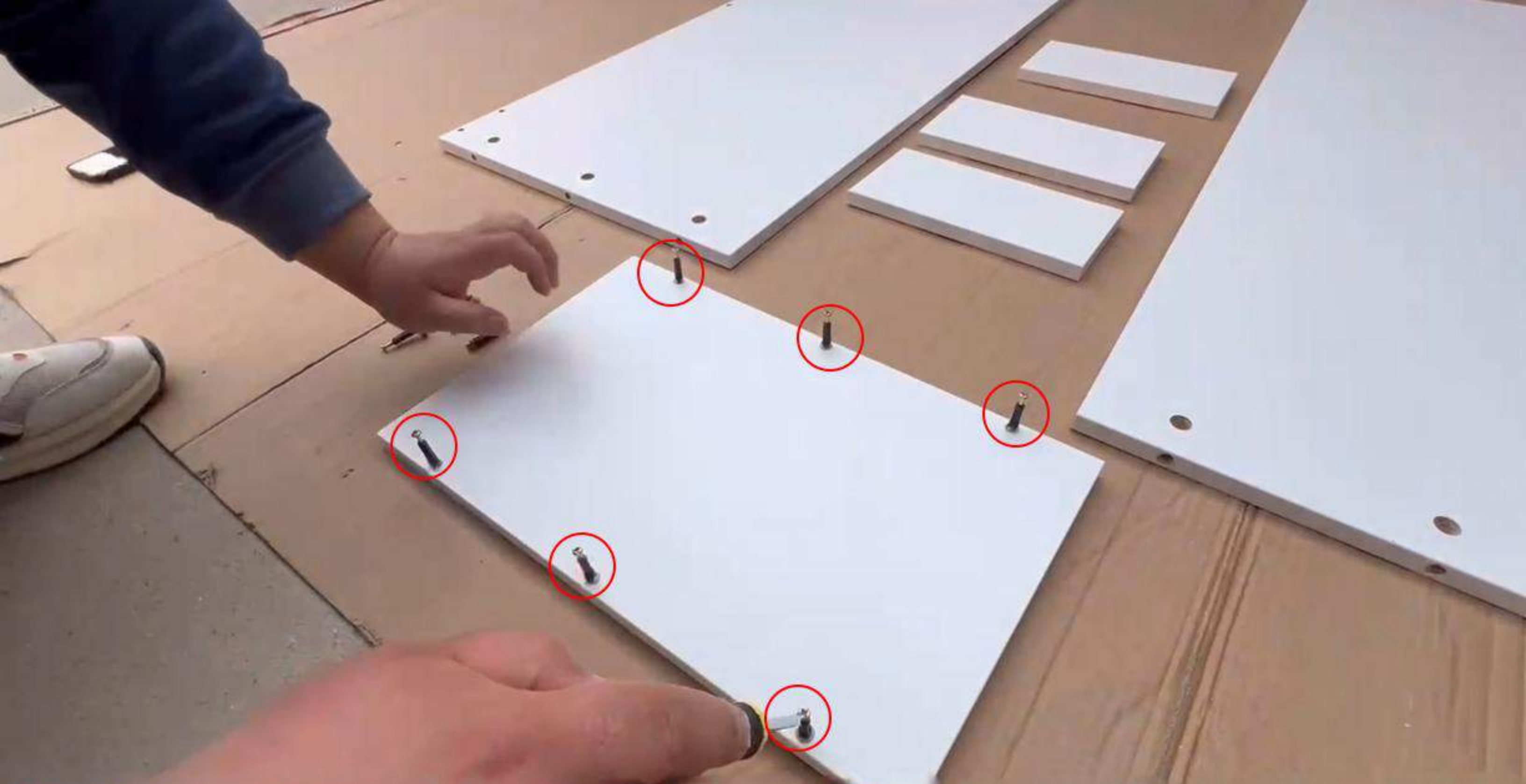

First, tighten the black screws on all the white embedded parts on the boards.

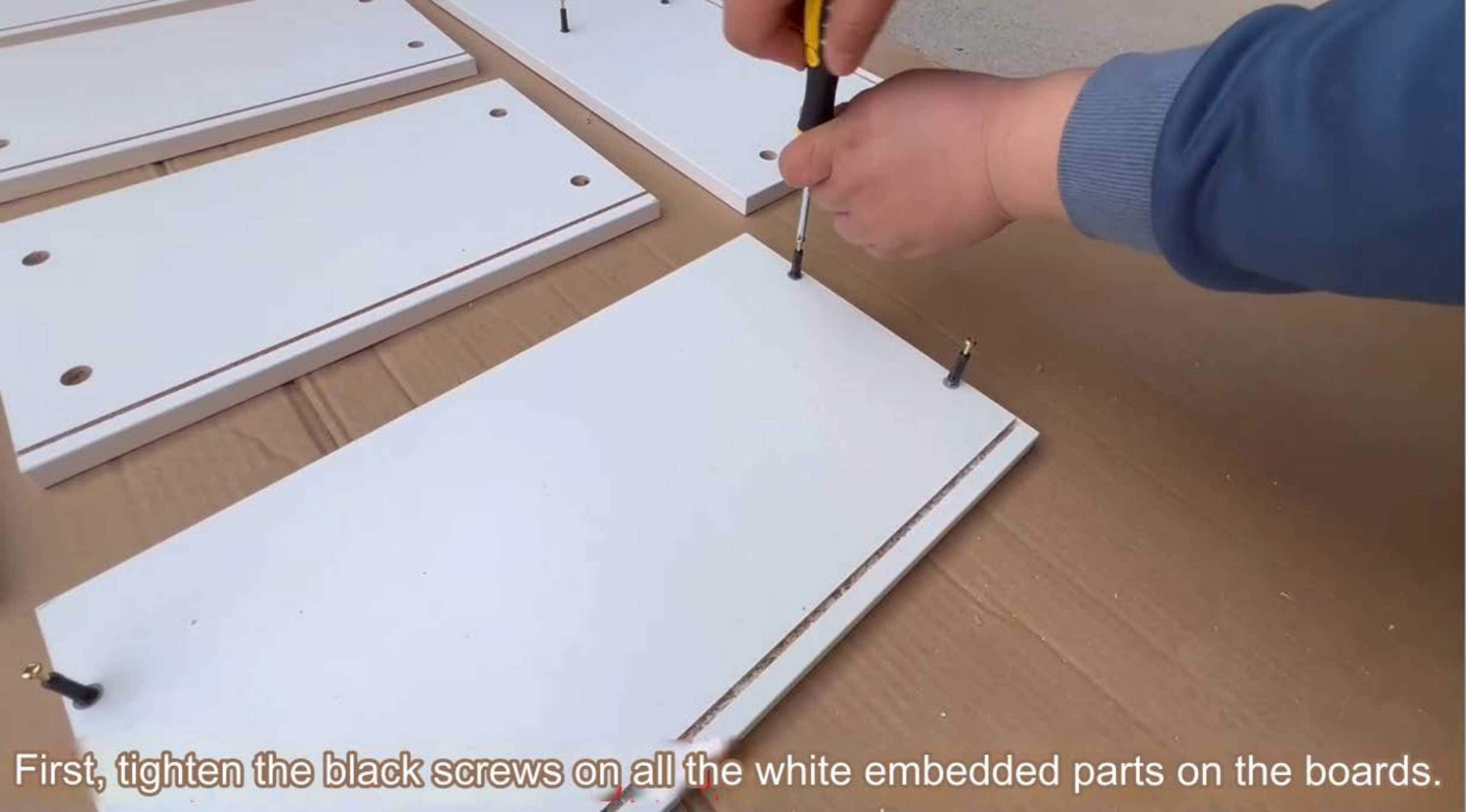

First, tighten the black screws on all the white embedded parts on the boards.

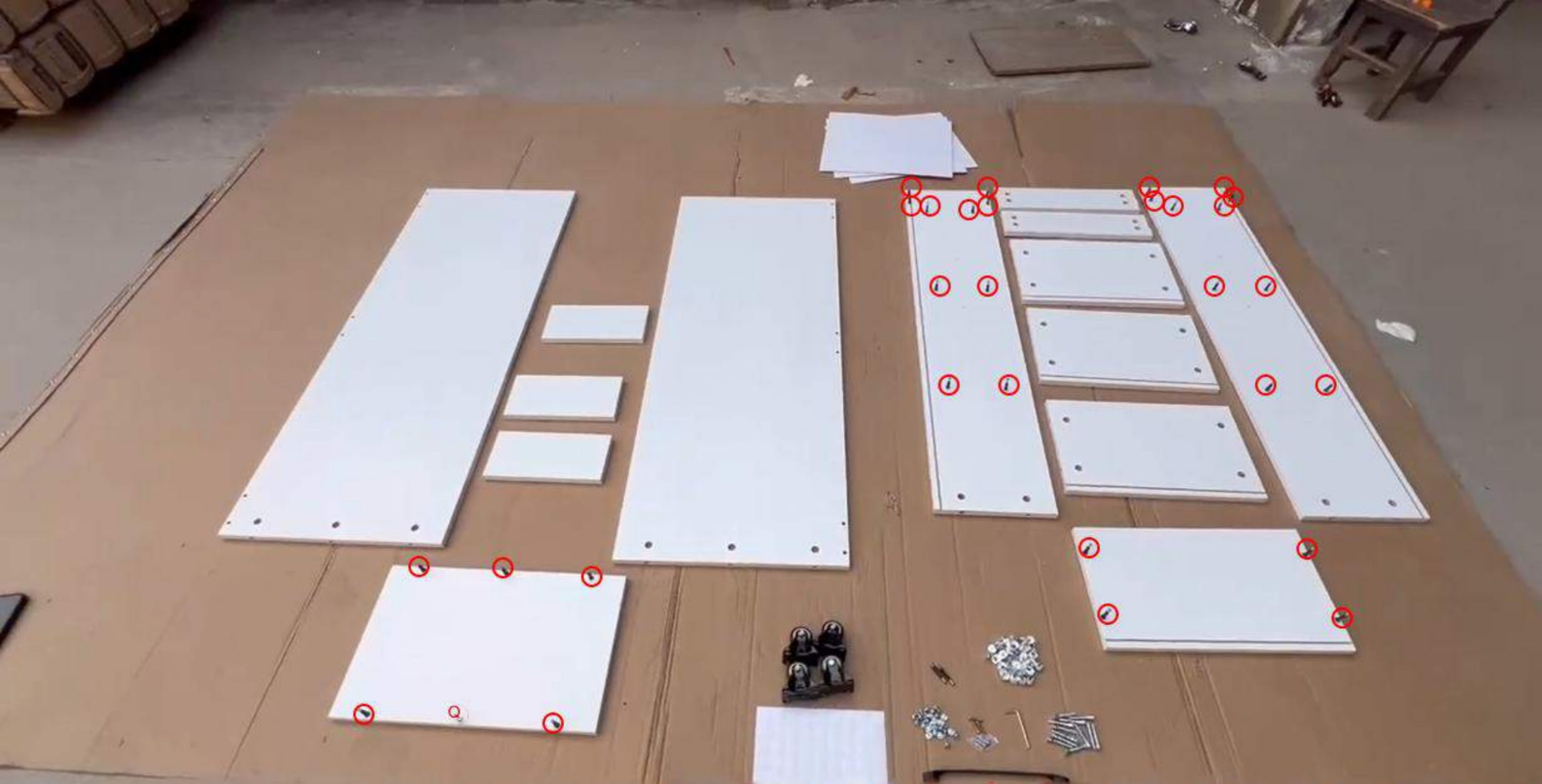

First, tighten the black screws on all the white embedded parts on the boards.

Splicing frame part

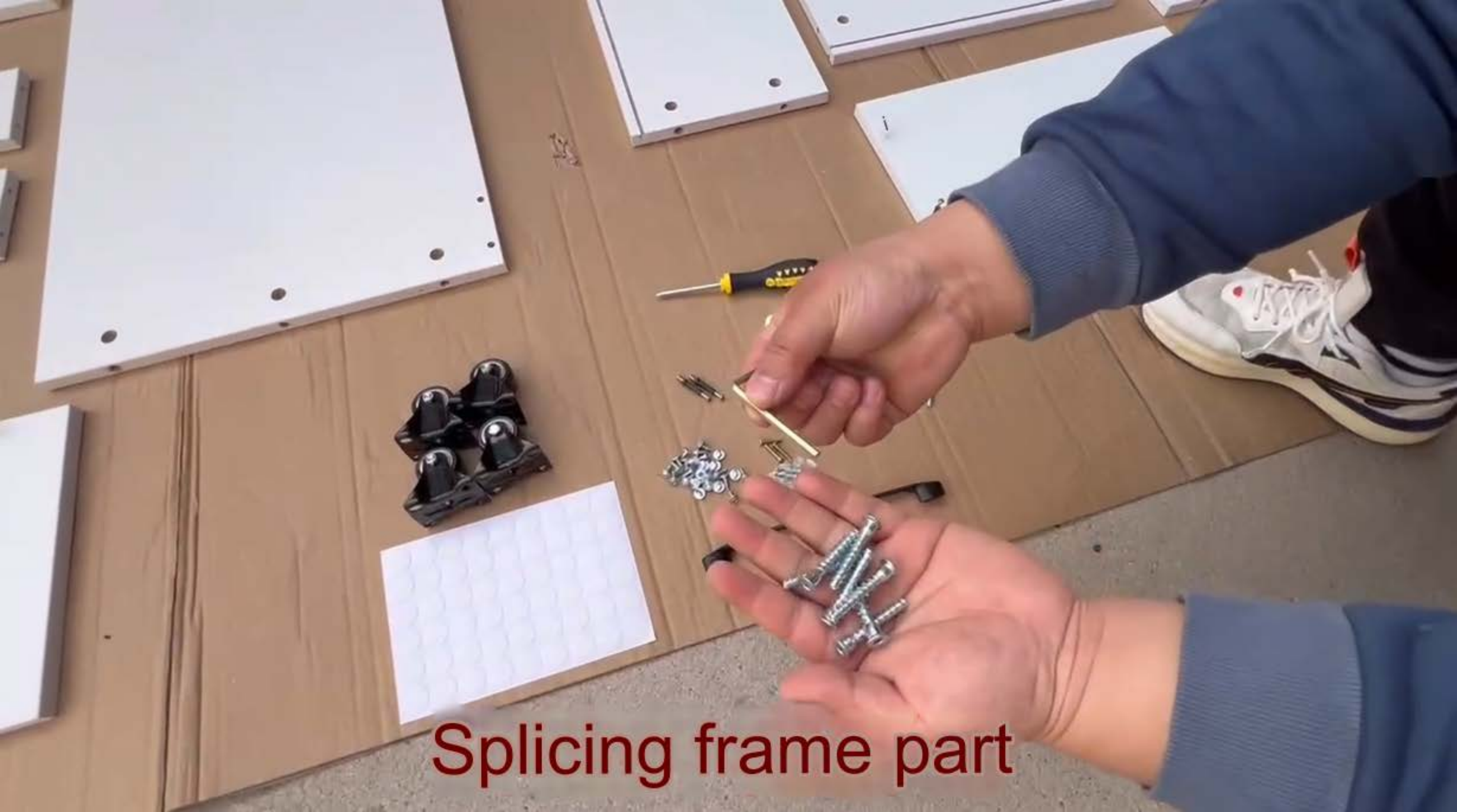

A person wearing a blue long-sleeved shirt and black pants is kneeling on a large sheet of brown cardboard. They are assembling a white frame structure. The frame consists of several white rectangular panels. One large panel is on the left, and another is on the right. A smaller white rectangular piece is being held by the person's hands in the center. A small pile of silver screws is on the cardboard near the person's hands. In the background, there are more white panels, some of which are already partially assembled. The scene is outdoors on a concrete surface.

Splicing frame part

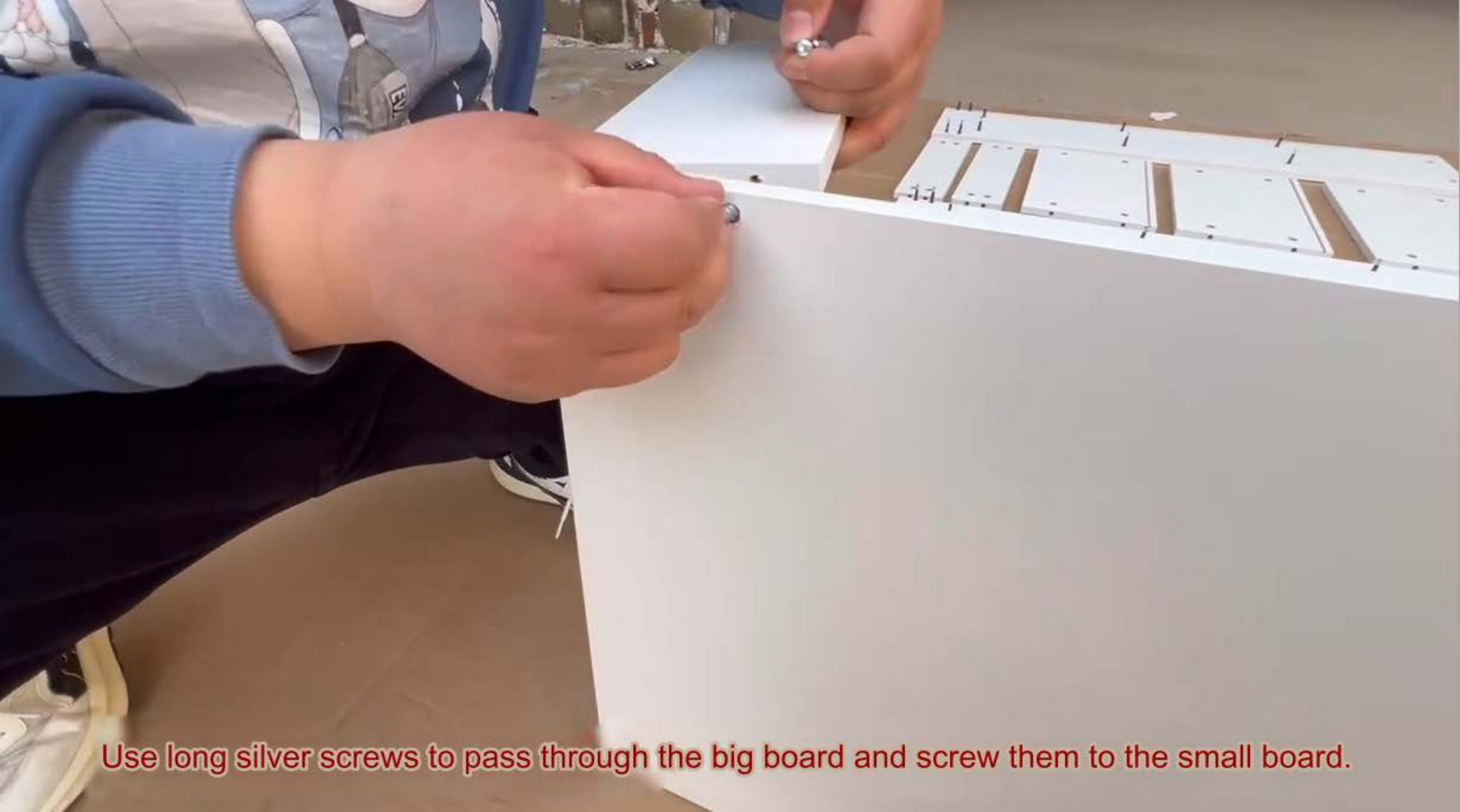

Use long silver screws to pass through the big board and screw them to the small board.



Use long silver screws to pass through the big board and screw them to the small board.

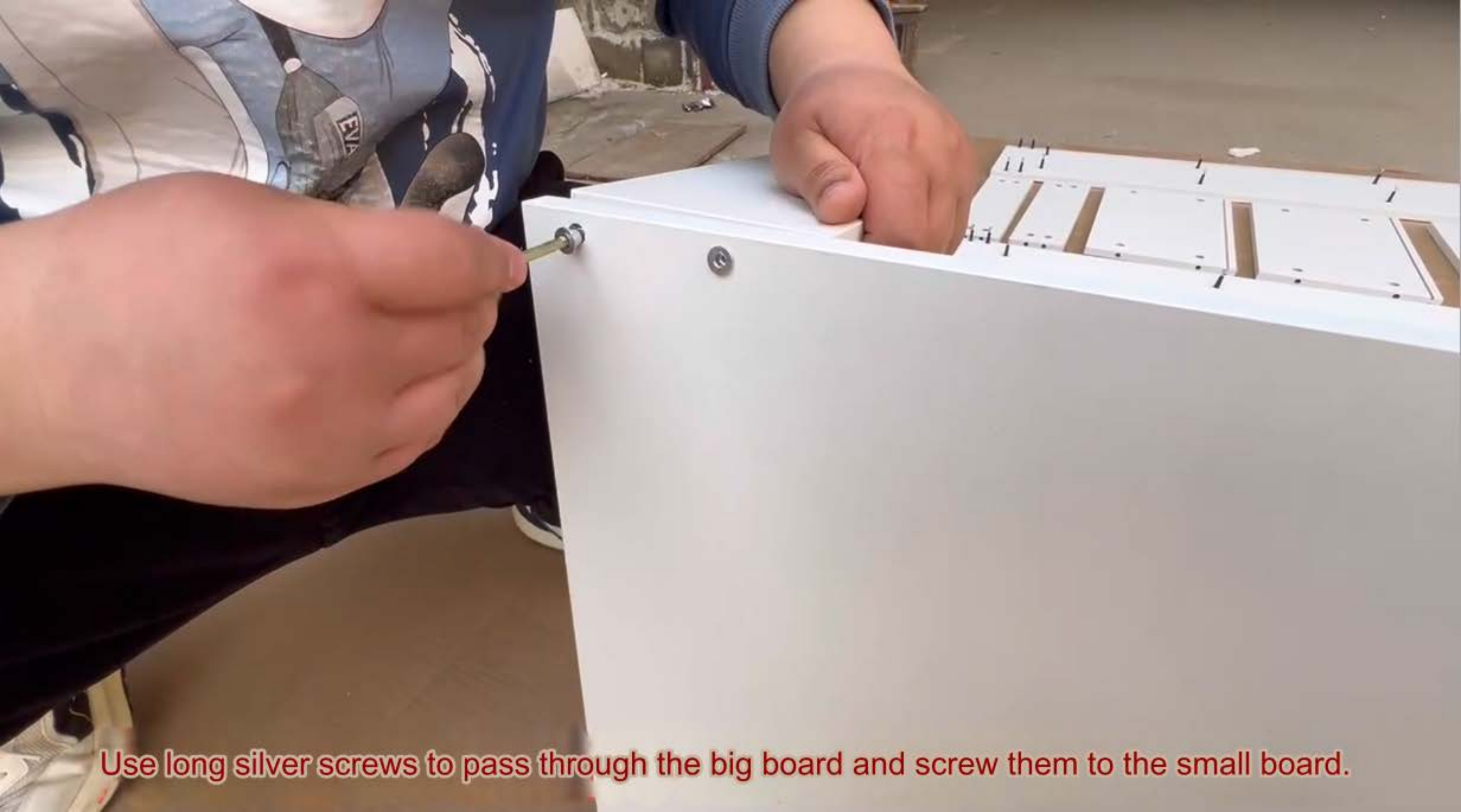

Use long silver screws to pass through the big board and screw them to the small board.

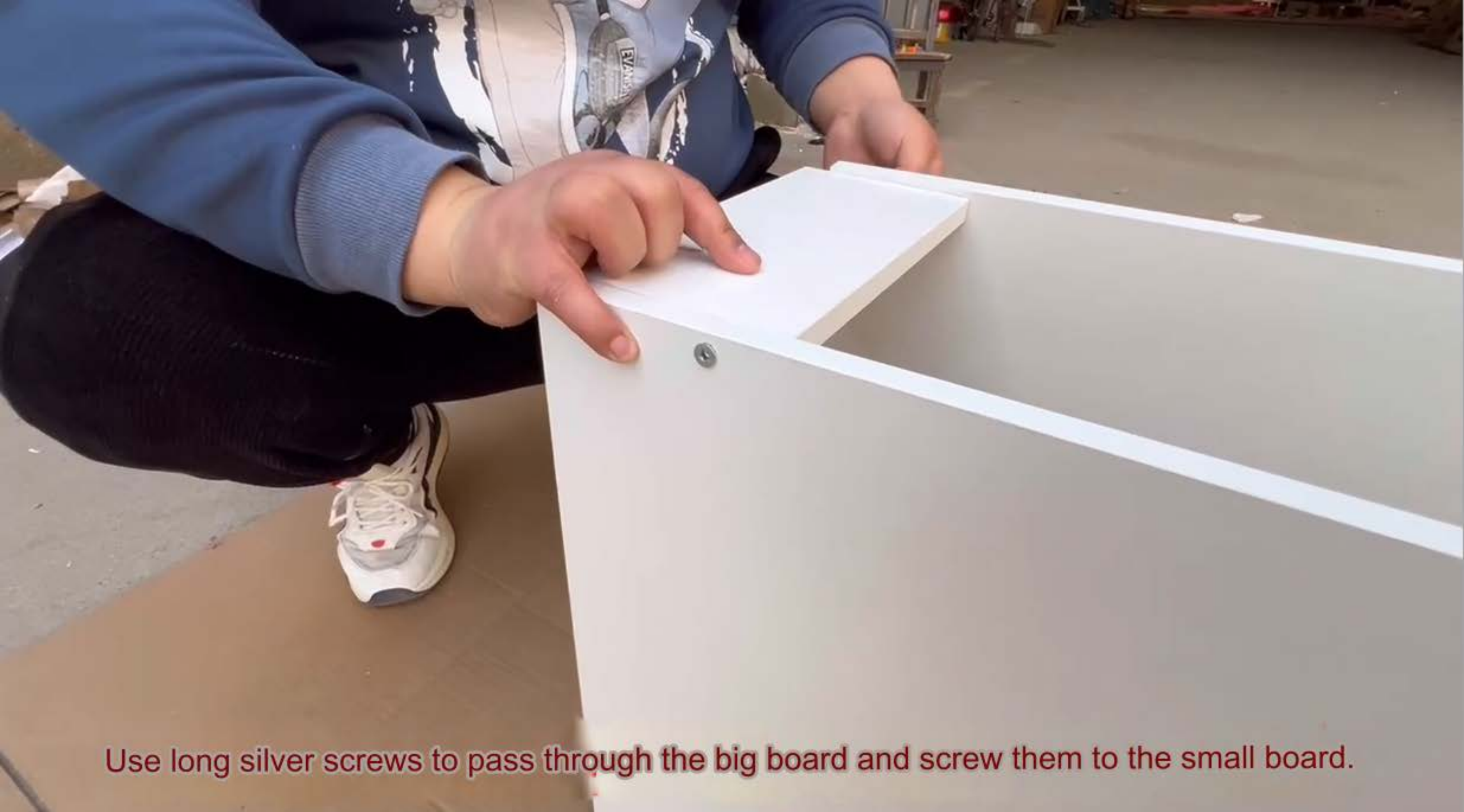

Use long silver screws to pass through the big board and screw them to the small board.

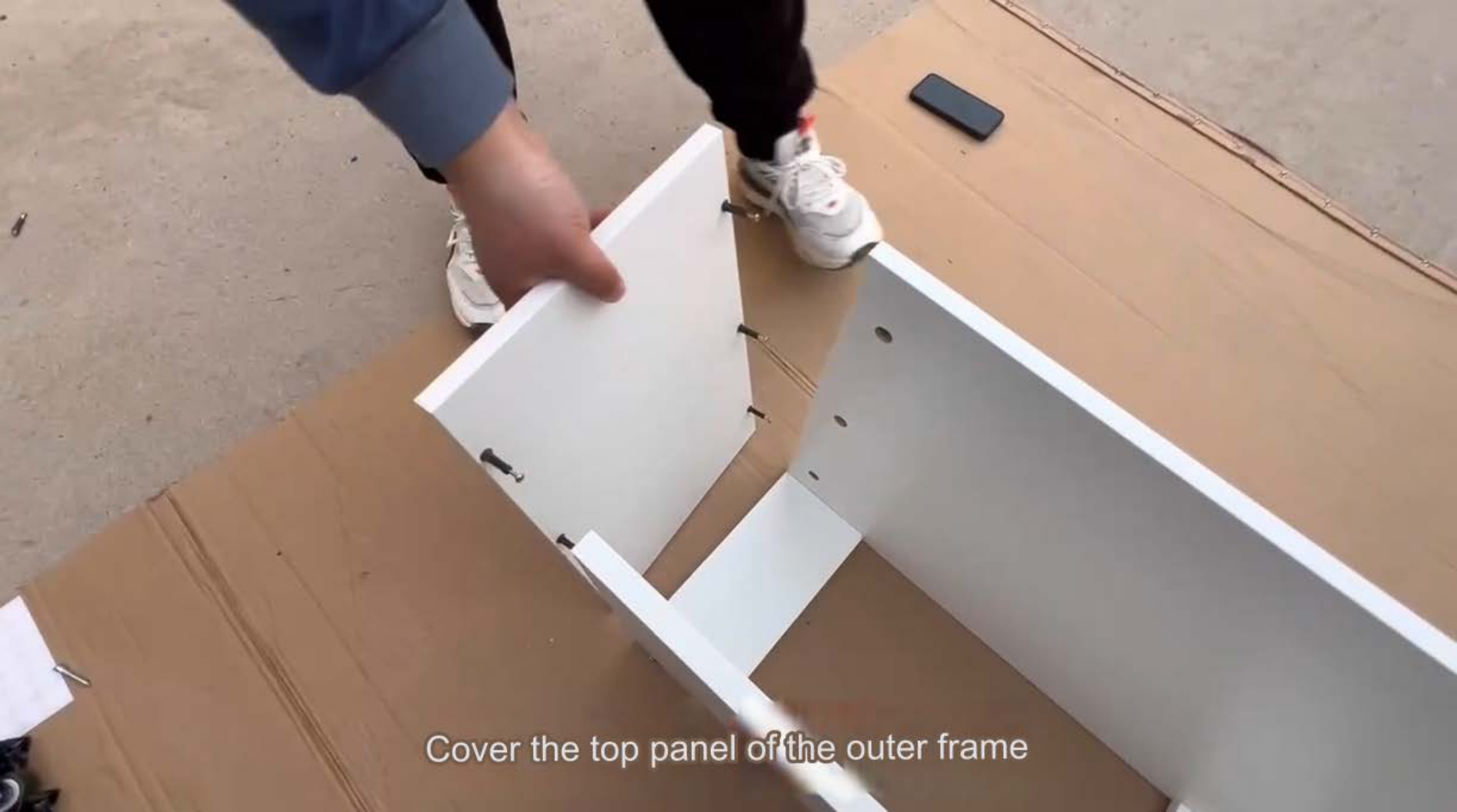

Cover the top panel of the outer frame



Cover the top panel of the outer frame



Put the round iron buckle into the big hole and tighten it clockwise



Put the round iron buckle into the big hole and tighten it clockwise



Put the round iron buckle into the big hole and tighten it clockwise

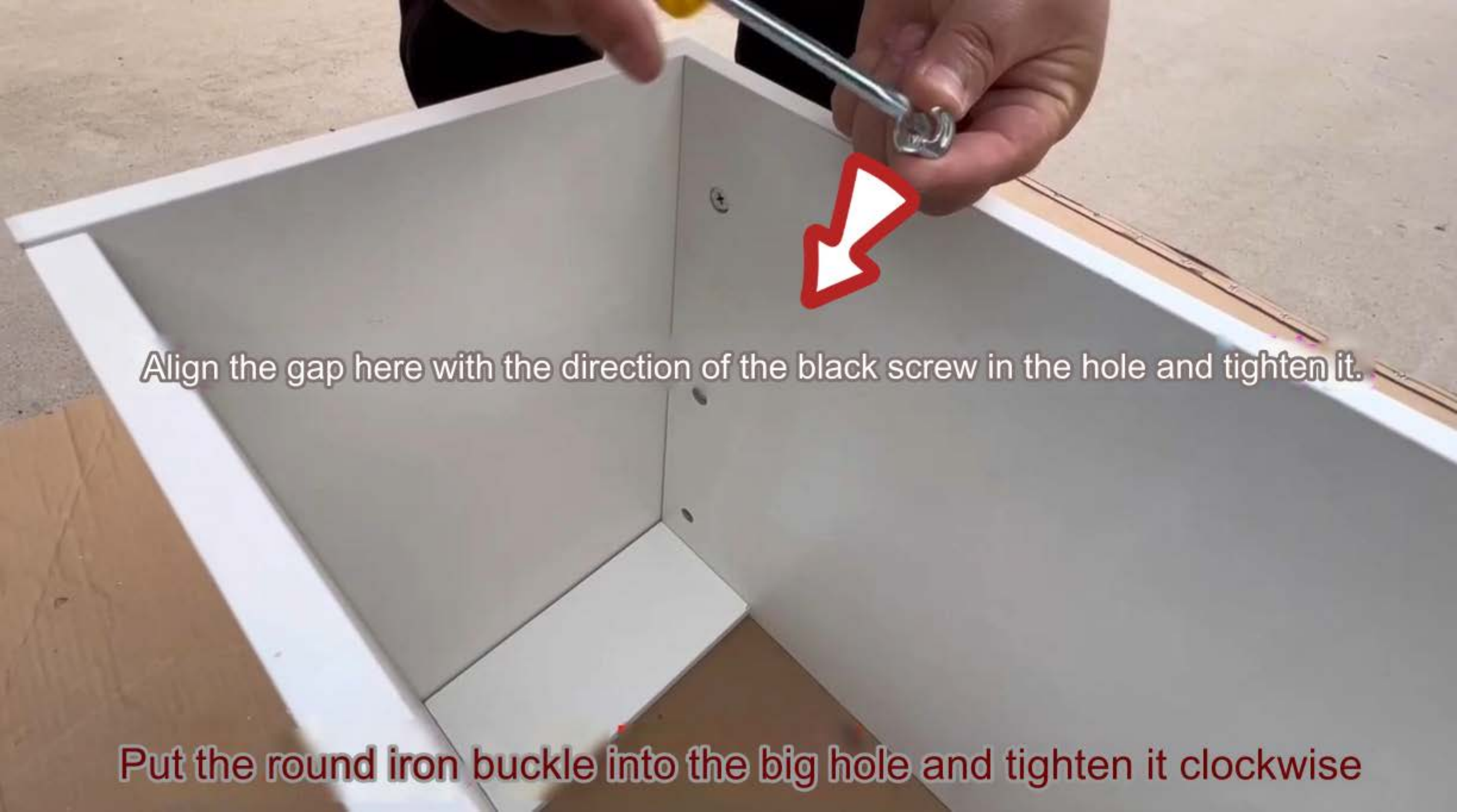

Align the gap here with the direction of the black screw in the hole and tighten it.

Put the round iron buckle into the big hole and tighten it clockwise



The outer frame is installed, lift it up and put it aside



Install sliding inner cabinets



Insert the small baffle and the shelf in turn and put in the round iron buckle and tighten it



Insert the small baffle and the shelf in turn and put in the round iron buckle and tighten it



Insert the small baffle and the shelf in turn and put in the round iron buckle and tighten it



Insert the small baffle and the shelf in turn and put in the round iron buckle and tighten it



Insert the small baffle and the shelf in turn and put in the round iron buckle and tighten it



Insert the small baffle and the shelf in turn and put in the round iron buckle and tighten it



Insert the small baffle and the shelf in turn and put in the round iron buckle and tighten it



Insert the small baffle and the shelf in turn and put in the round iron buckle and tighten it



Insert the small baffle and the shelf in turn and put in the round iron buckle and tighten it



Insert the thin back plate in the middle, making sure that the left, right and bottom sides are completely inserted into the slot.



Insert the thin back plate in the middle, making sure the left, right and bottom are completely stuck into the slot.



Cover it with another long board, making sure the backboard is completely inserted into the slot.



Cover it with another long board, making sure the backboard is completely inserted into the slot.



Use self-tapping screws on the bottom plate to screw on the wheels and screw in holes.



Use self-tapping screws on the bottom plate to screw on the wheels and screw in several holes.



Use self-tapping screws on the bottom plate to screw on the wheels and find several holes.





back plate at the bottom into the slot, pay attention to insert the thin



Cover the bottom plate



Cover the bottom plate



Put round iron buckles into all the big holes and tighten them



Put round iron buckles into all the big holes and tighten them



● Put round iron buckles into all big holes and tighten them



Raise the cabinet and install the handle



Raise the cabinet and install the handle



Raise the cabinet and install the handle



Push inside the outer frame and the installation is completed