

Furniture installation



Please be sure to use a manual screwdriver and refrain from using an electric drill.

Installation process of TV cabinet call= table

sum TV003





D0*40



D0*40



B3*20



A1*32



K20*20



L56*2



L55*6



D7*2



Screwdriver

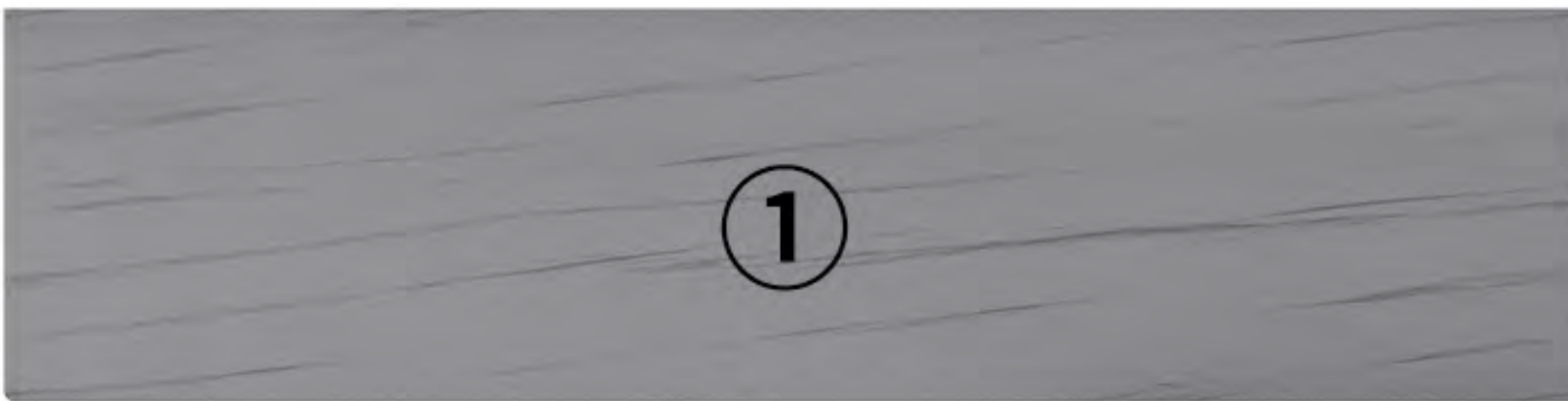

1



7



4



6



9



14



15

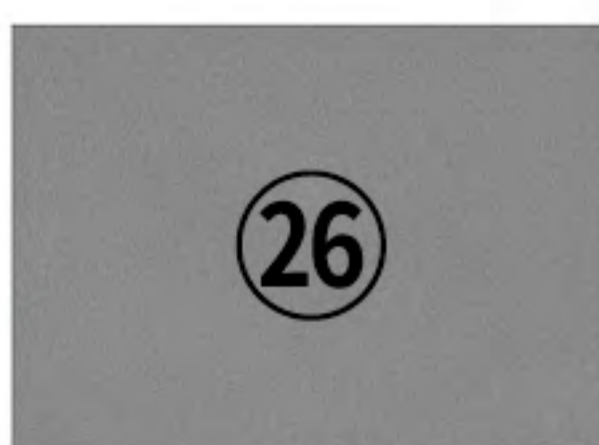
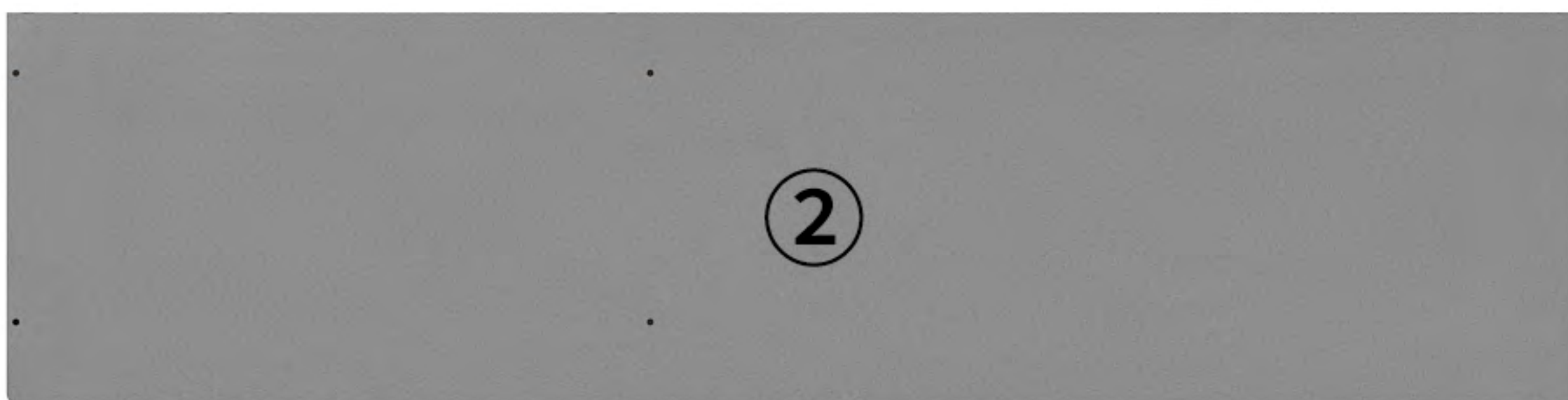
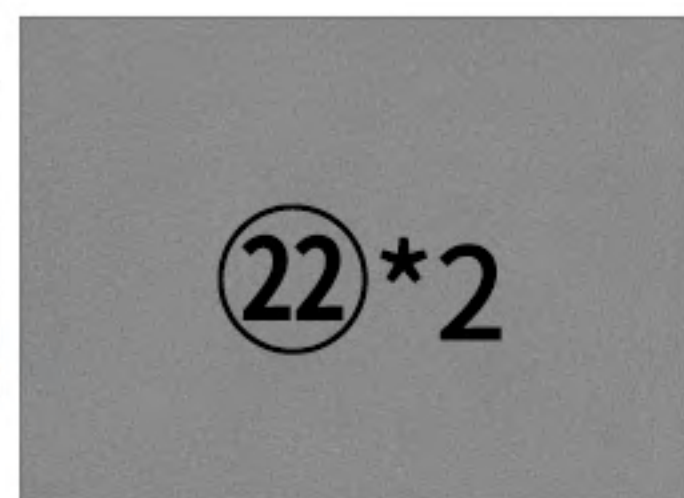
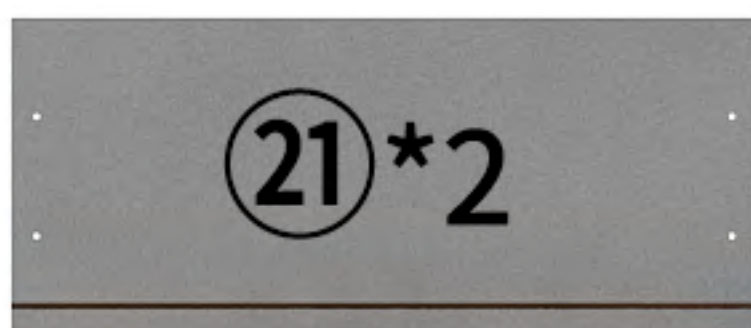
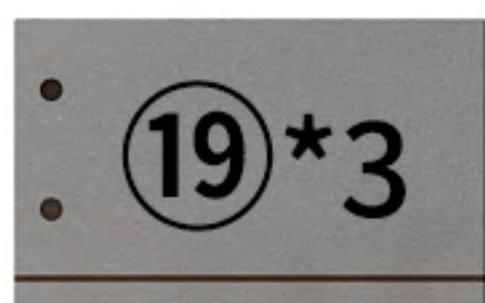

Presentation of finished product



Product Split Diagram

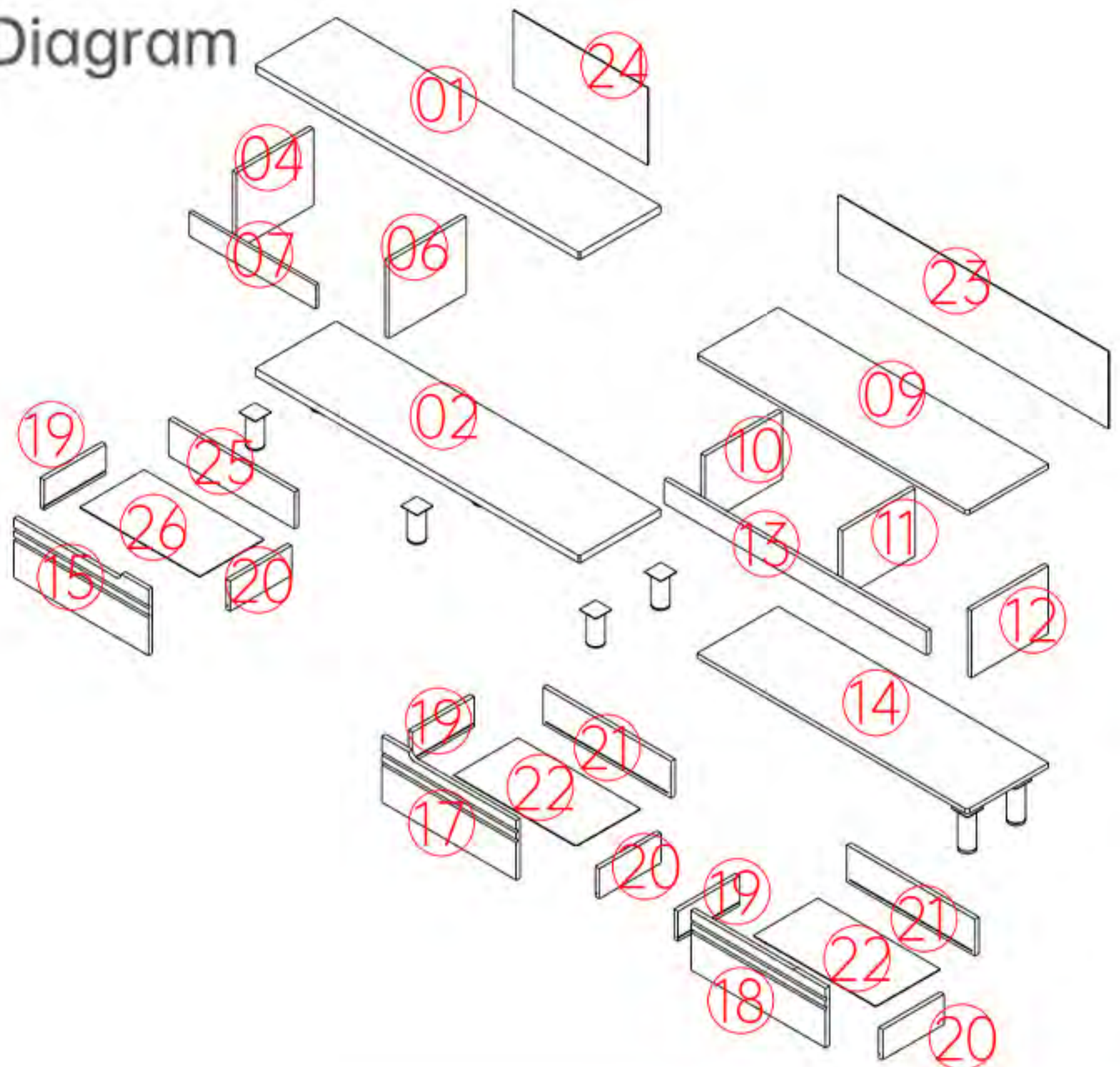

Installation method of eccentric screw

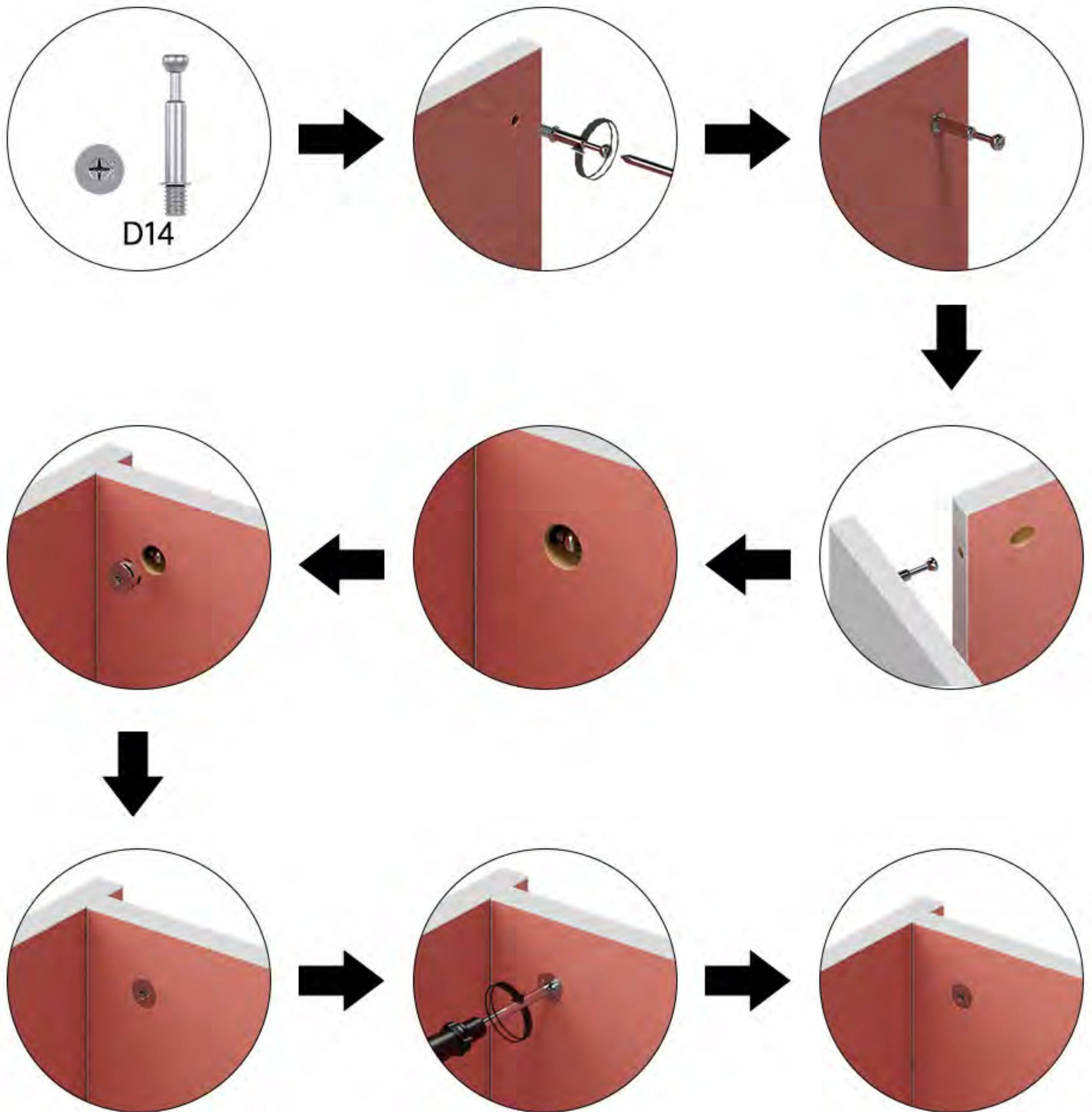

1

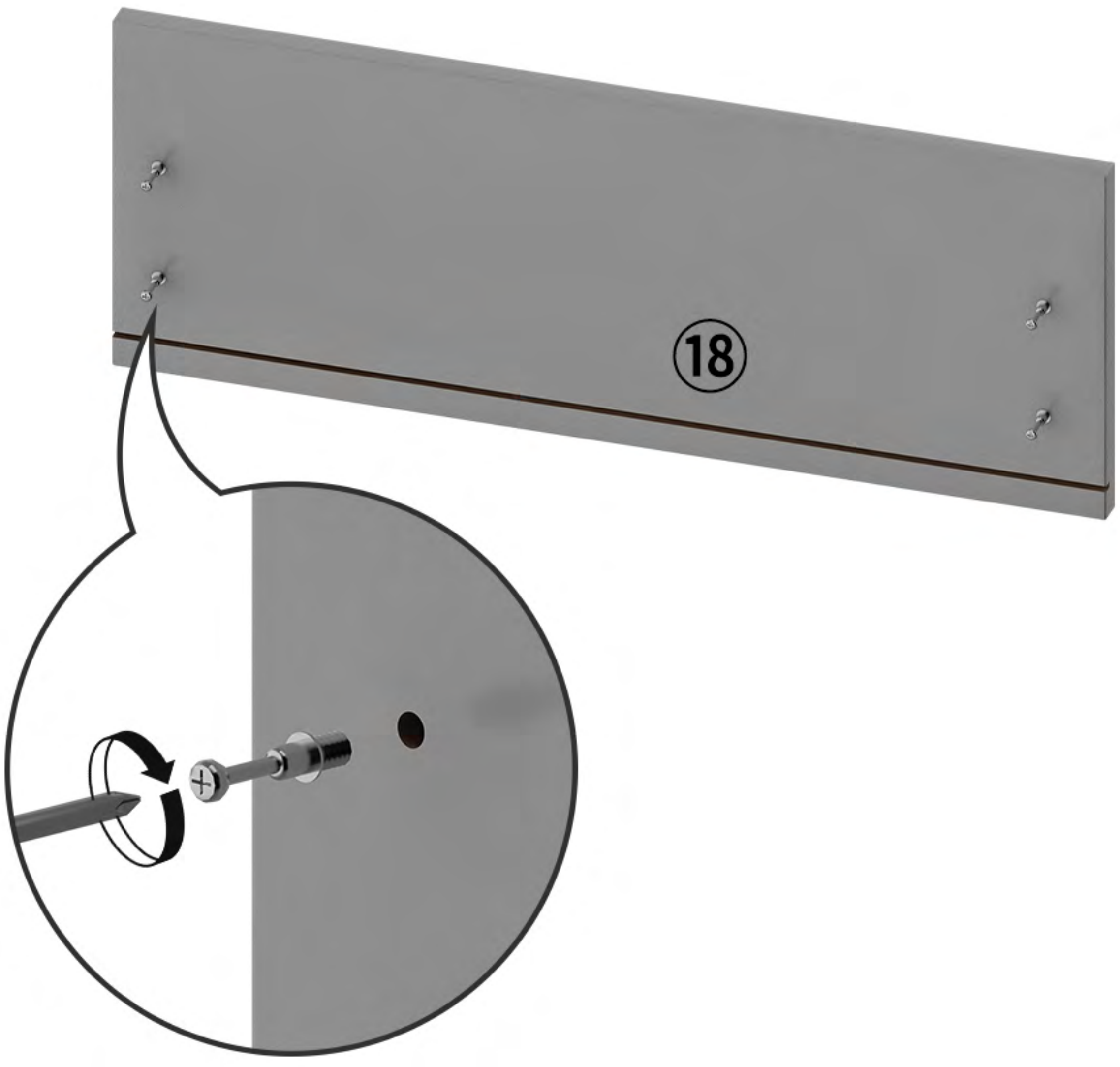

2

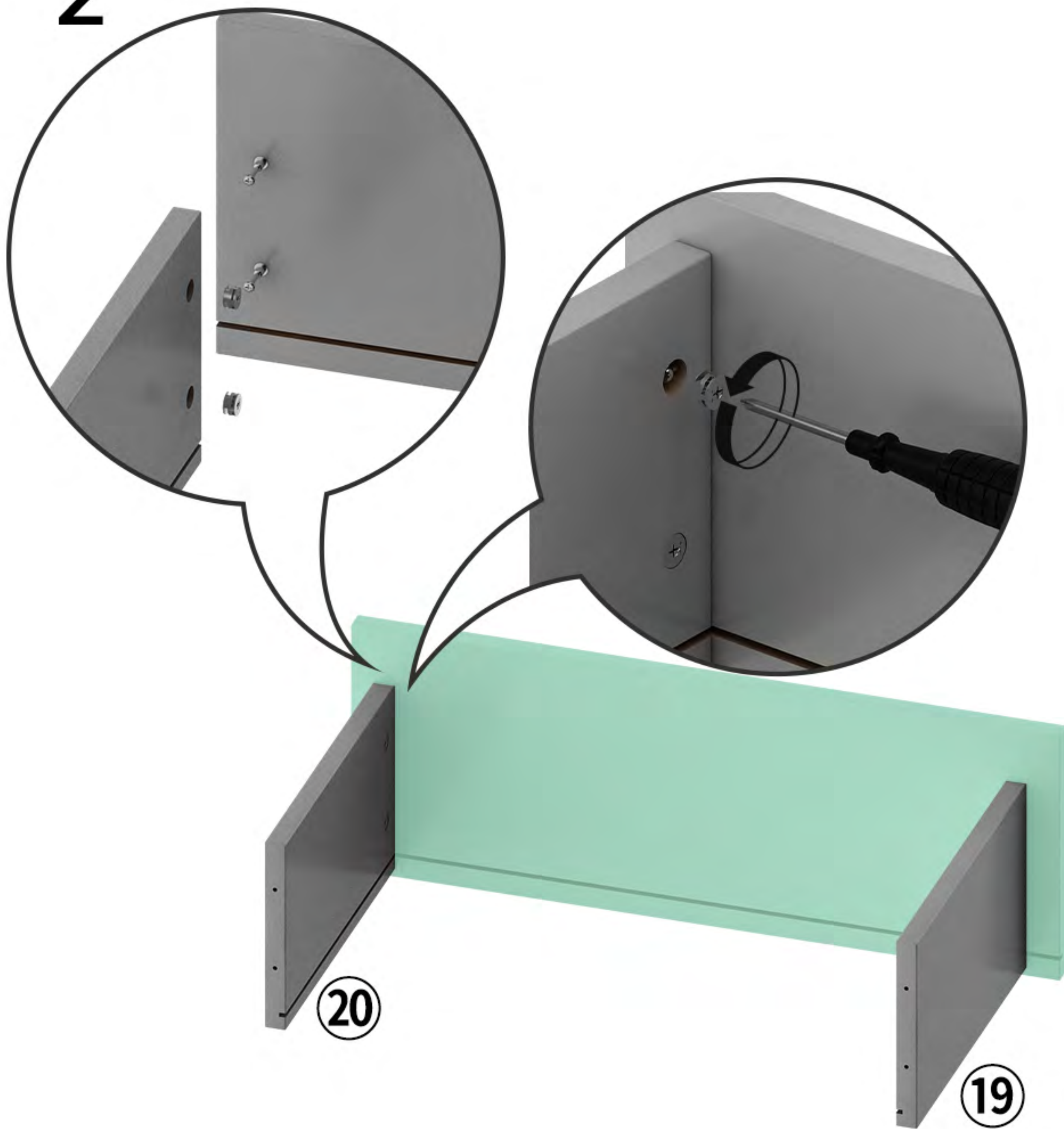

3

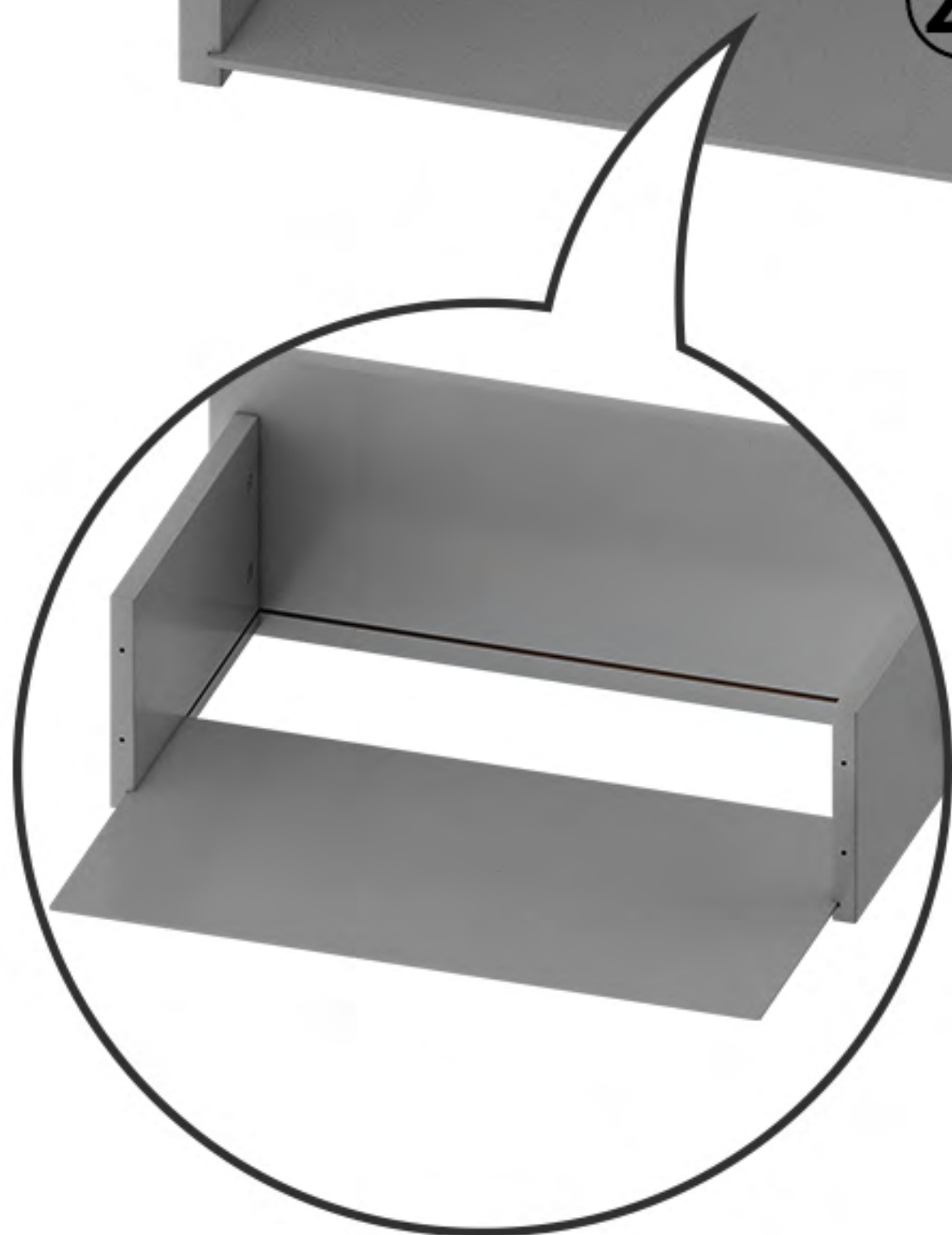

4

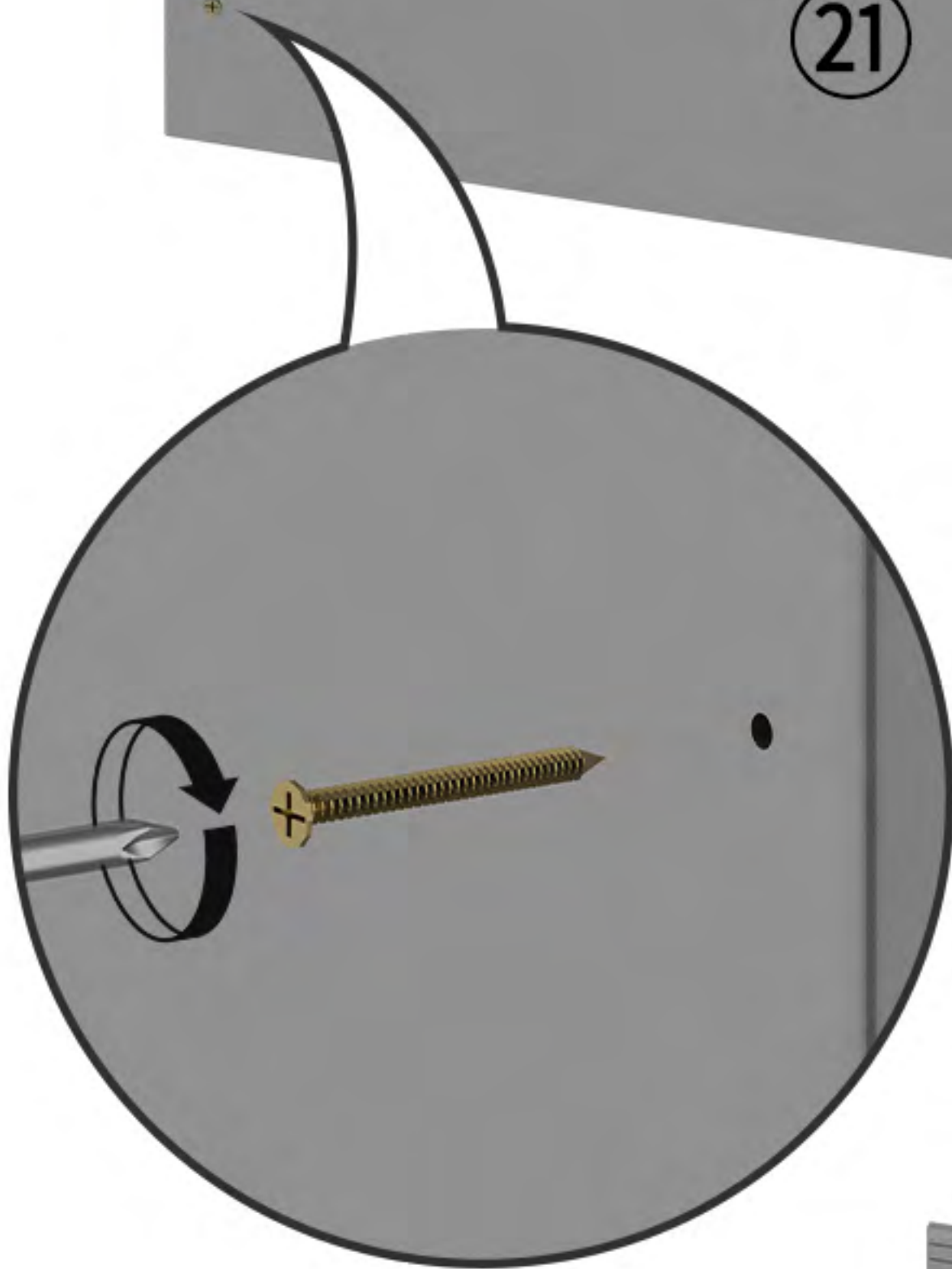
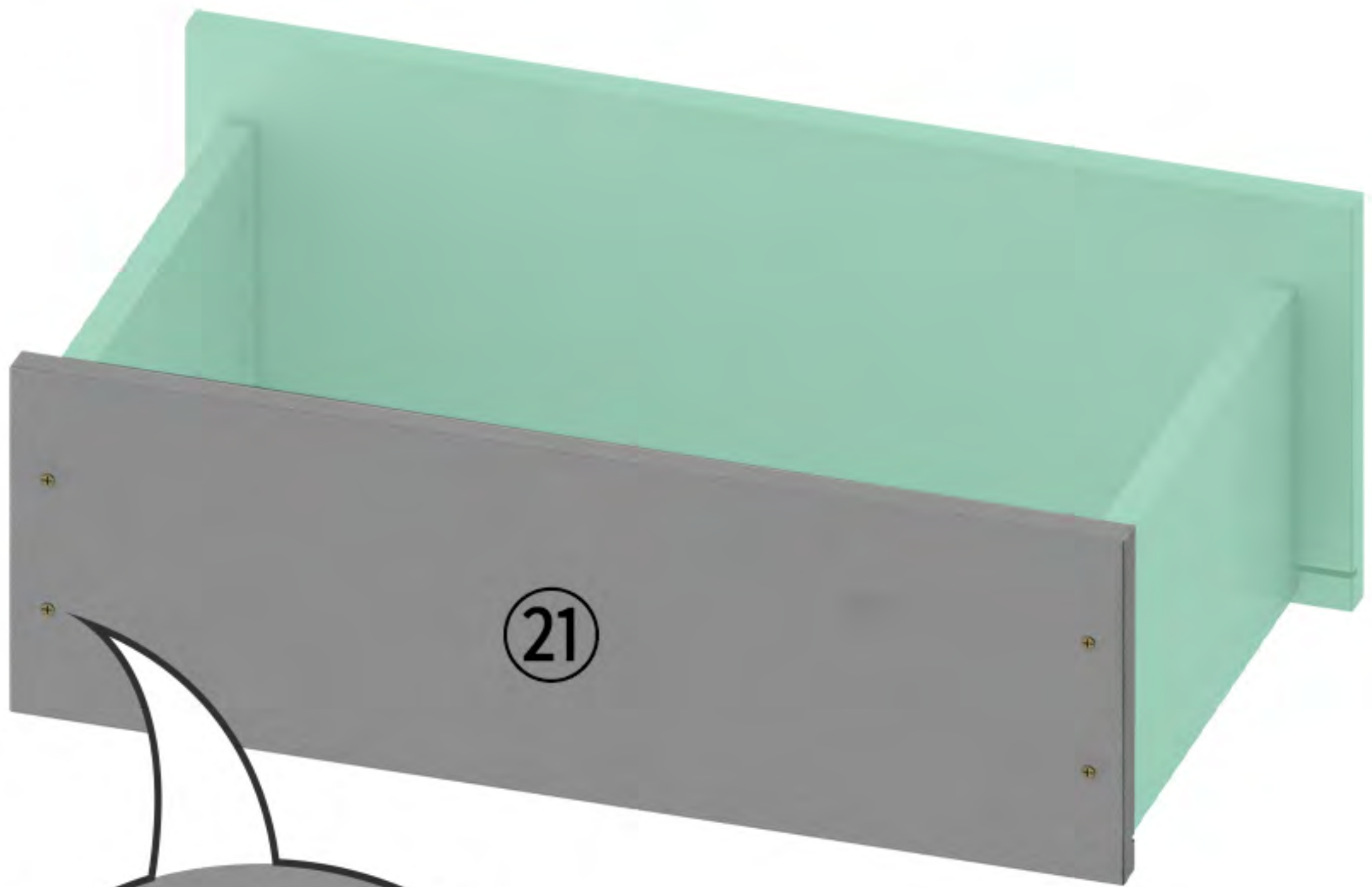

The installation method for the three drawers is identical, and it can be assembled following the product disassembly diagram.



5

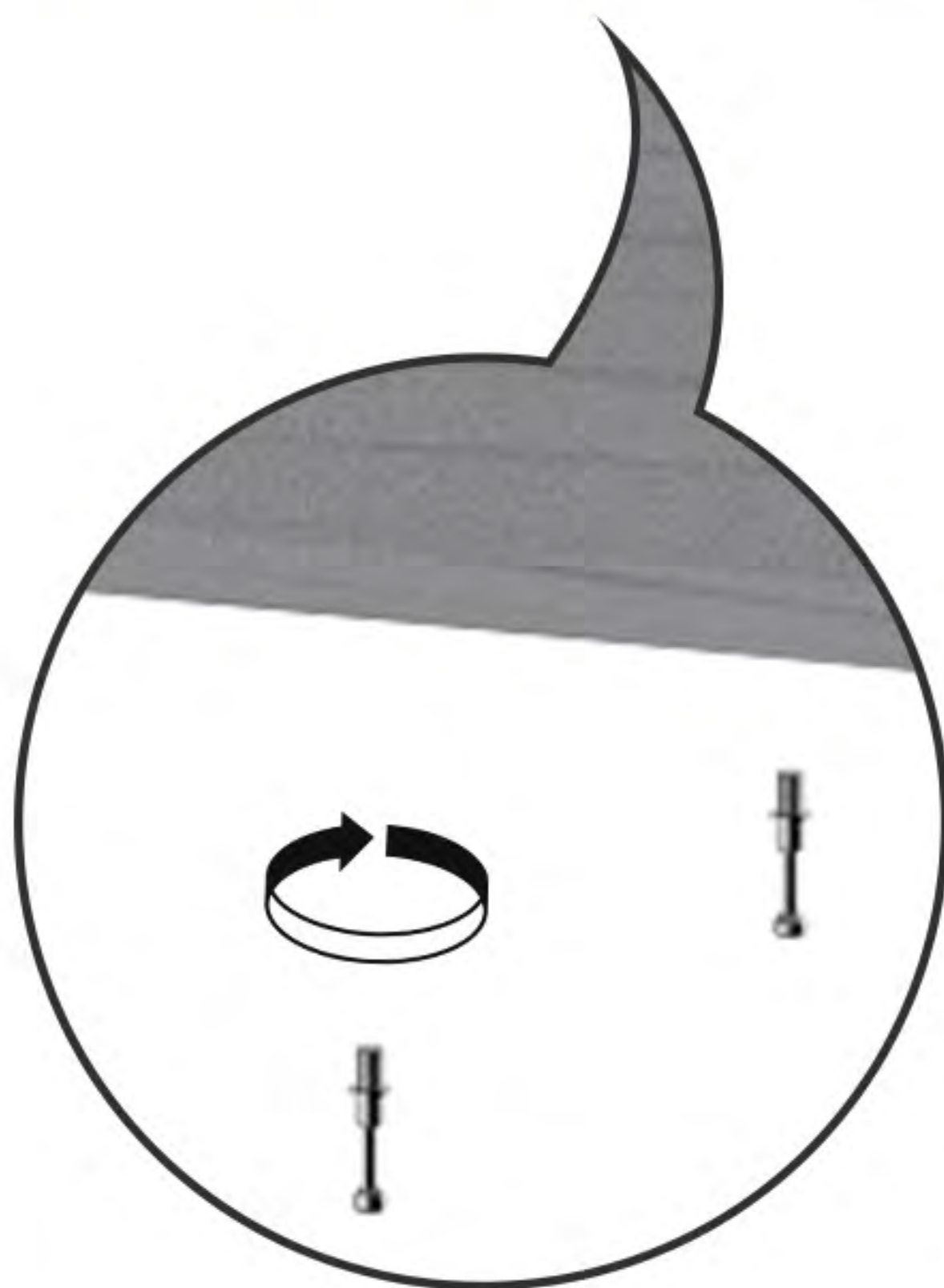

6

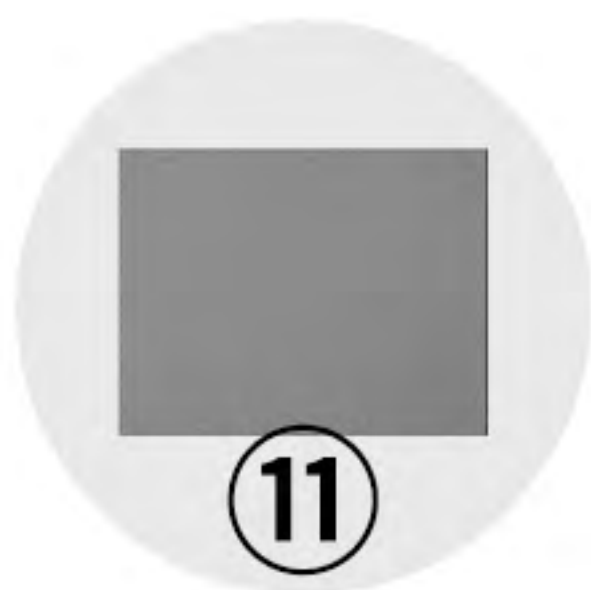
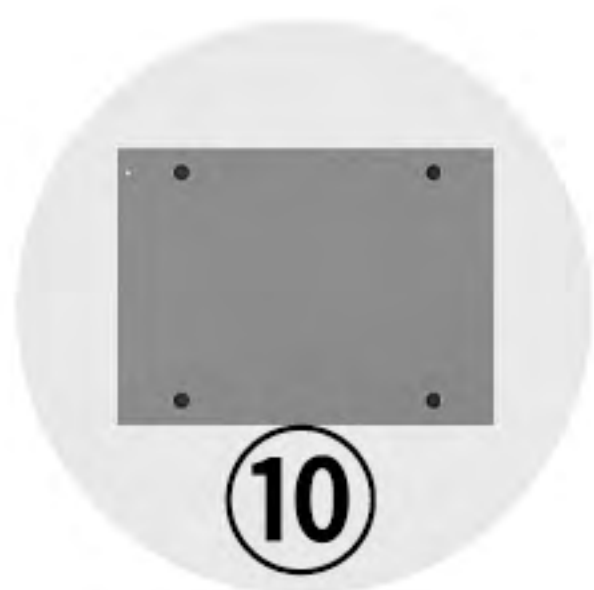
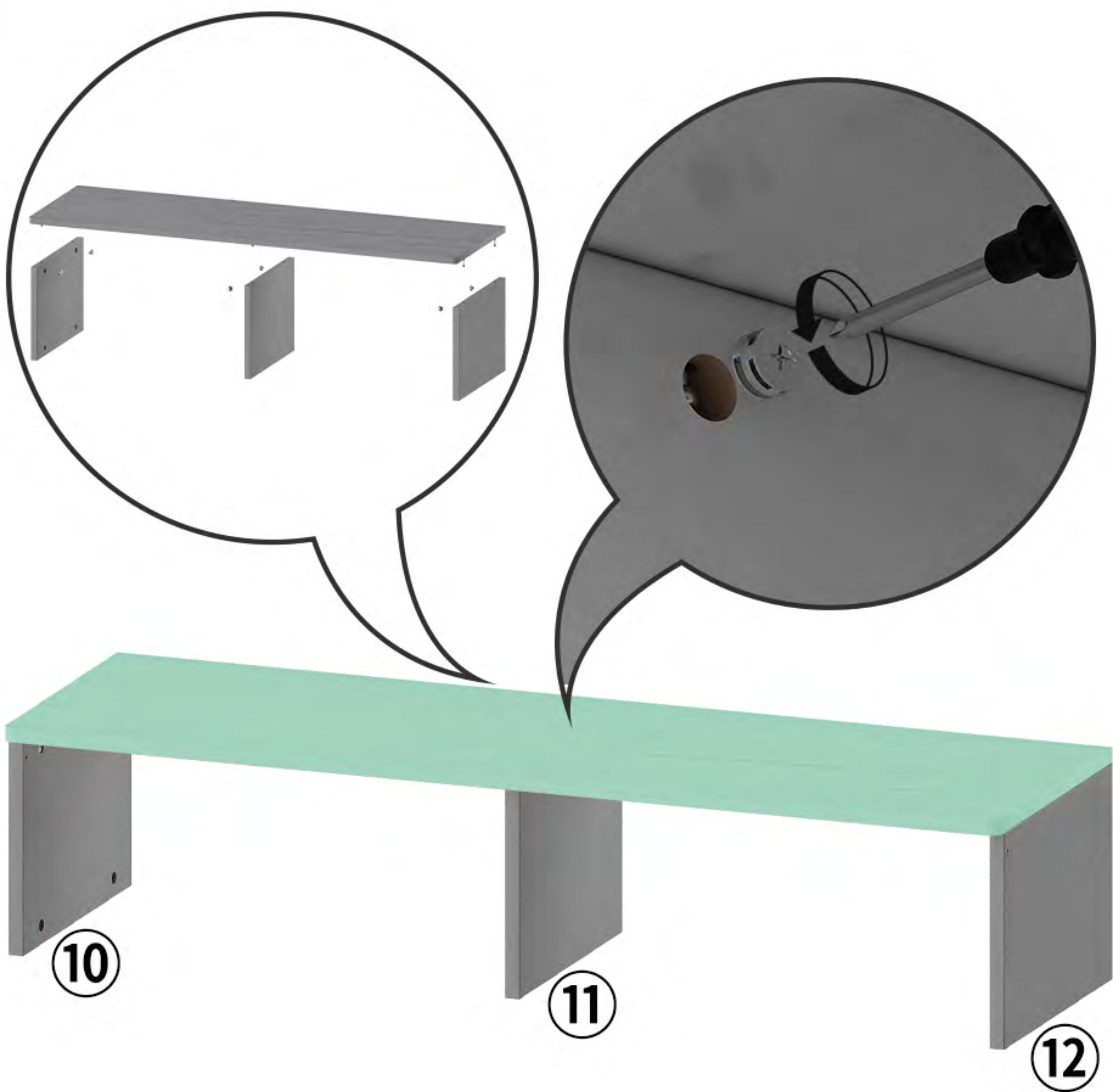

7

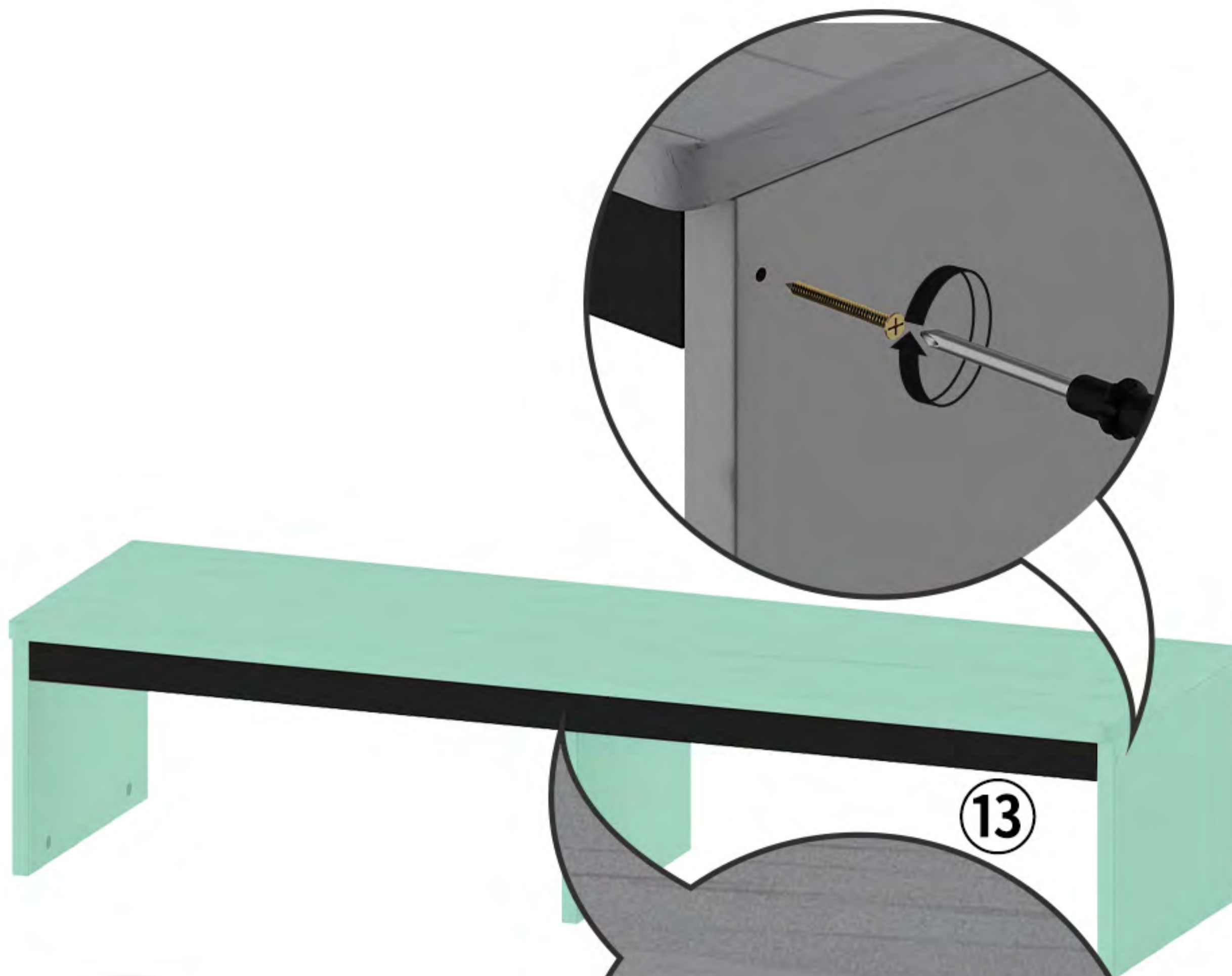

D7



13



B3

8

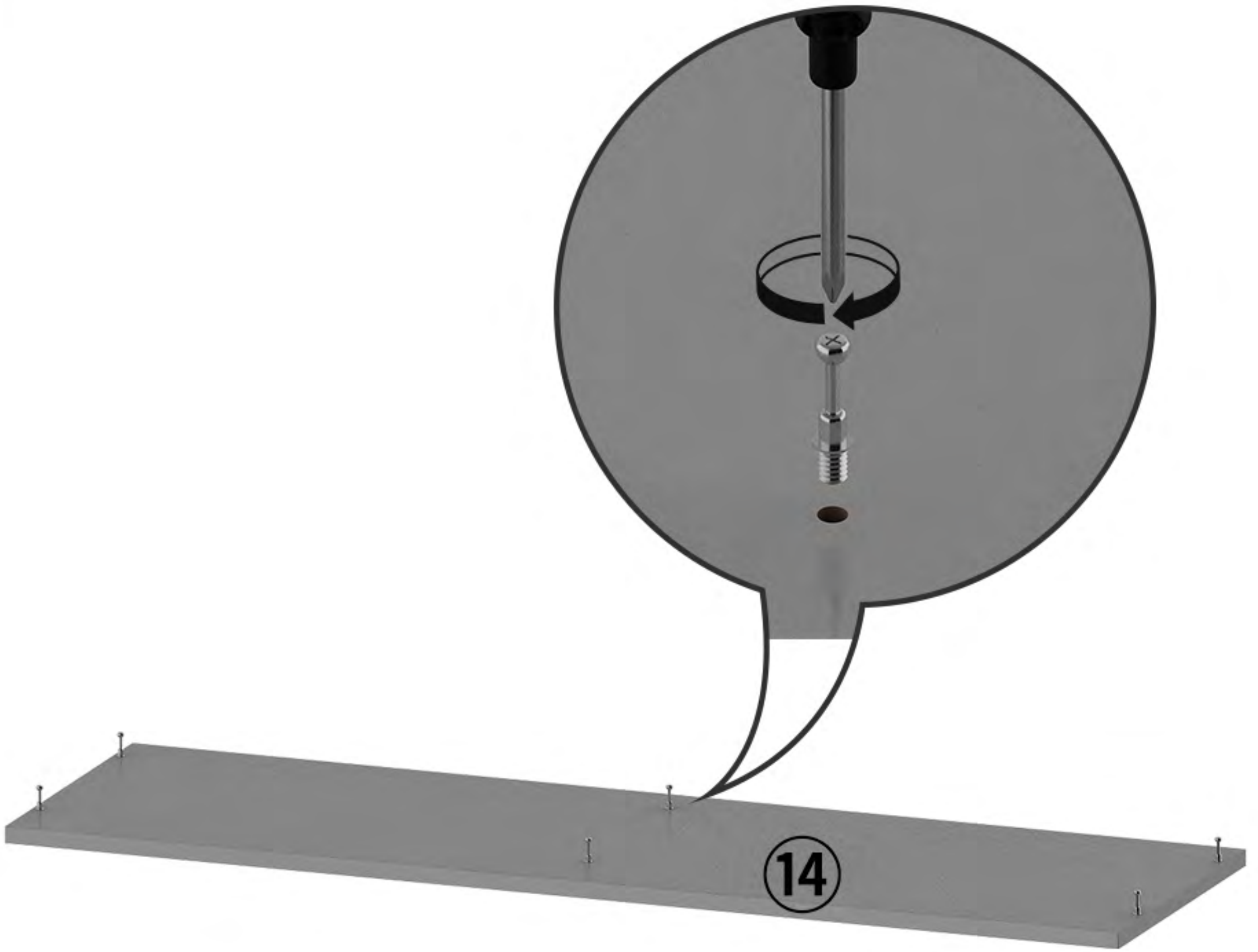

9

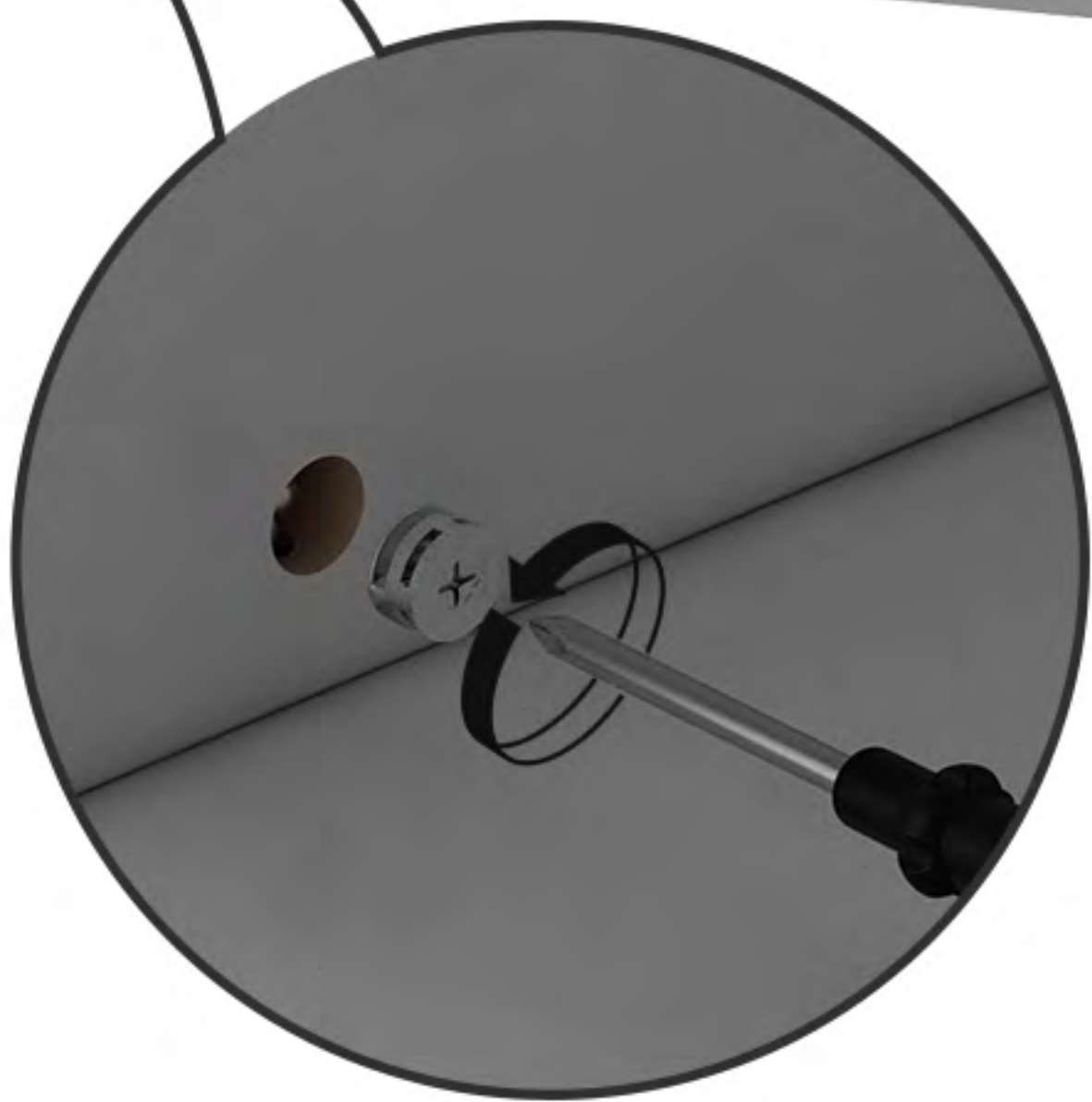

10



11

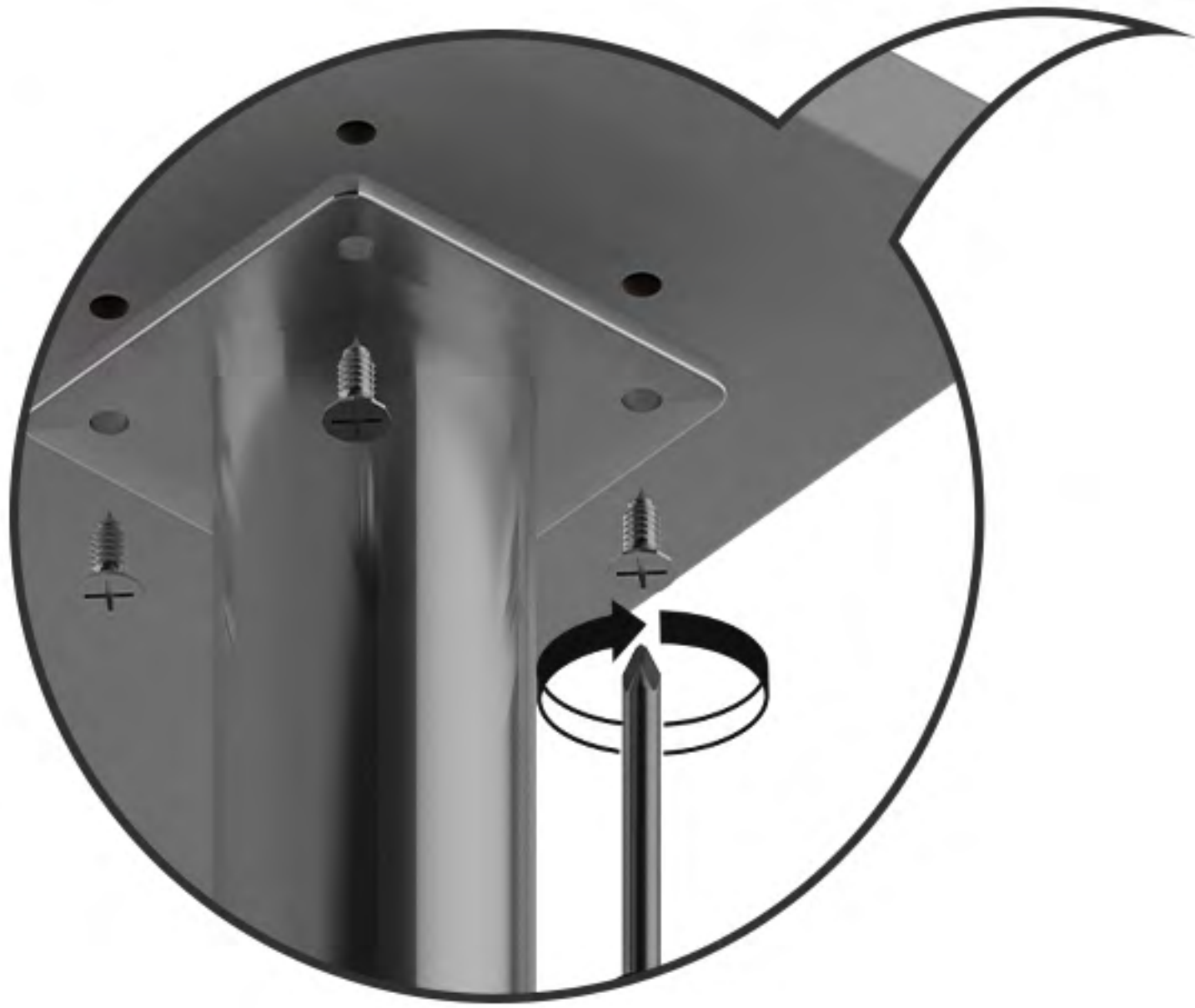

12

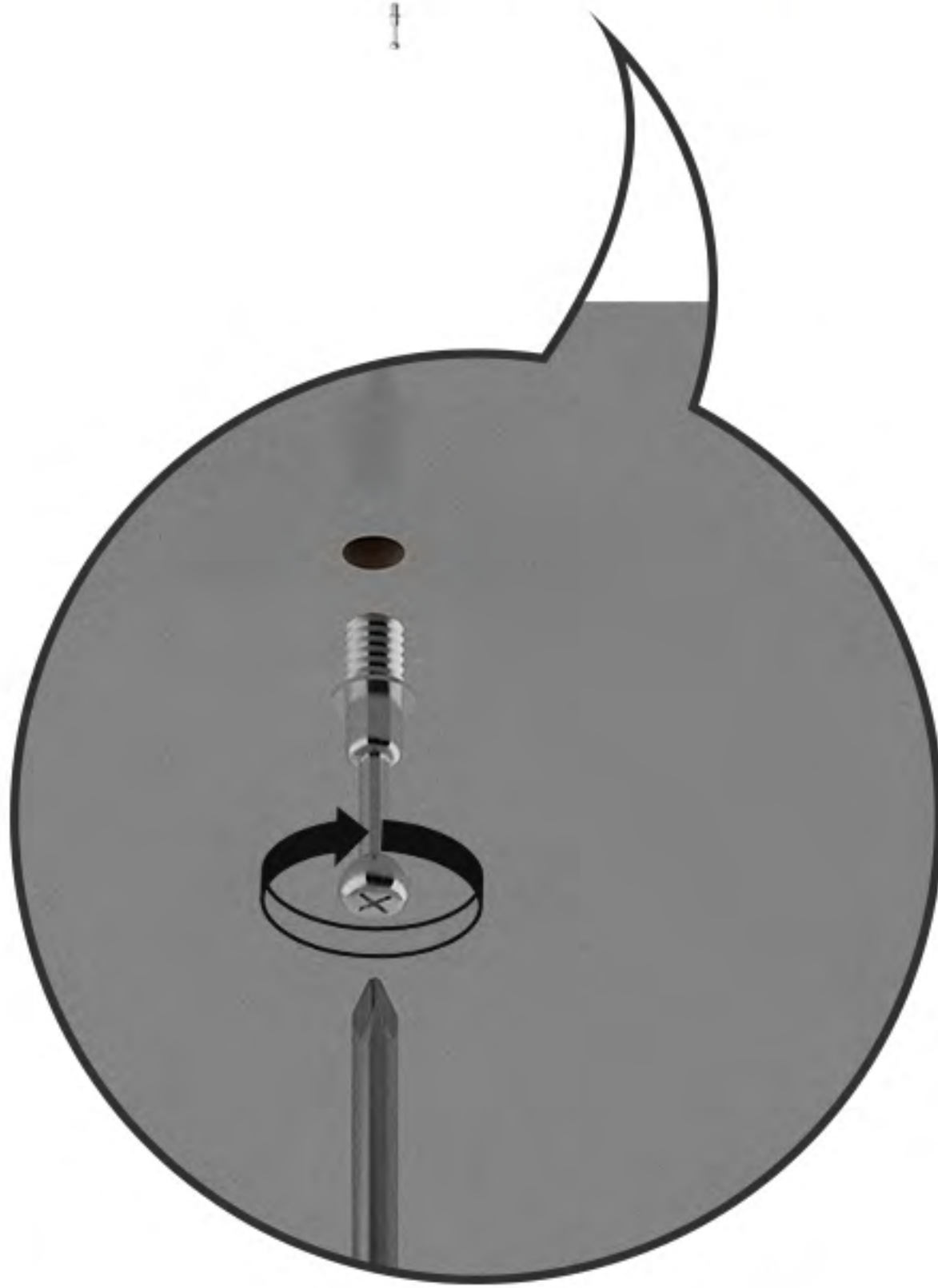
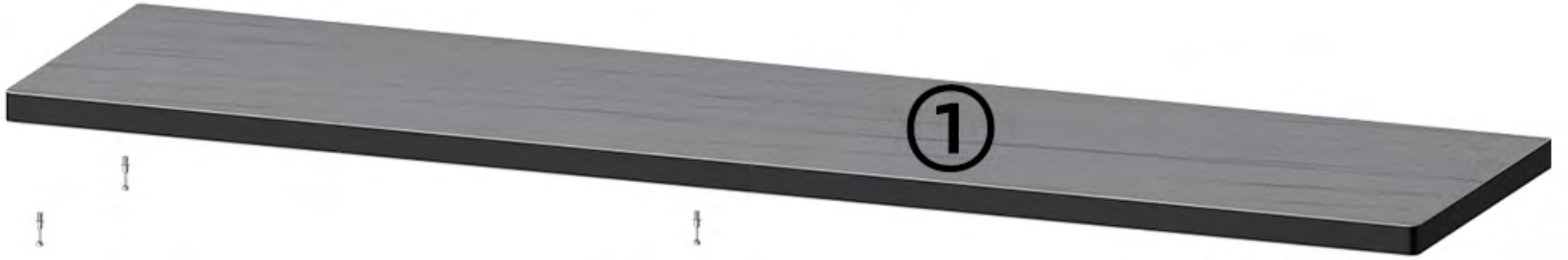

13

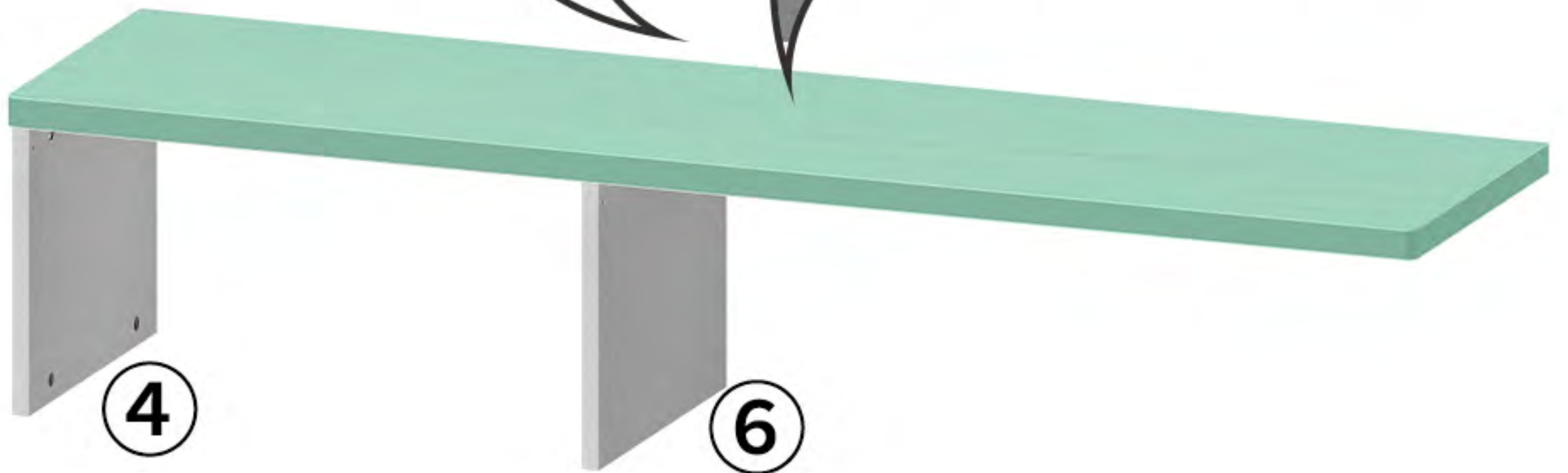
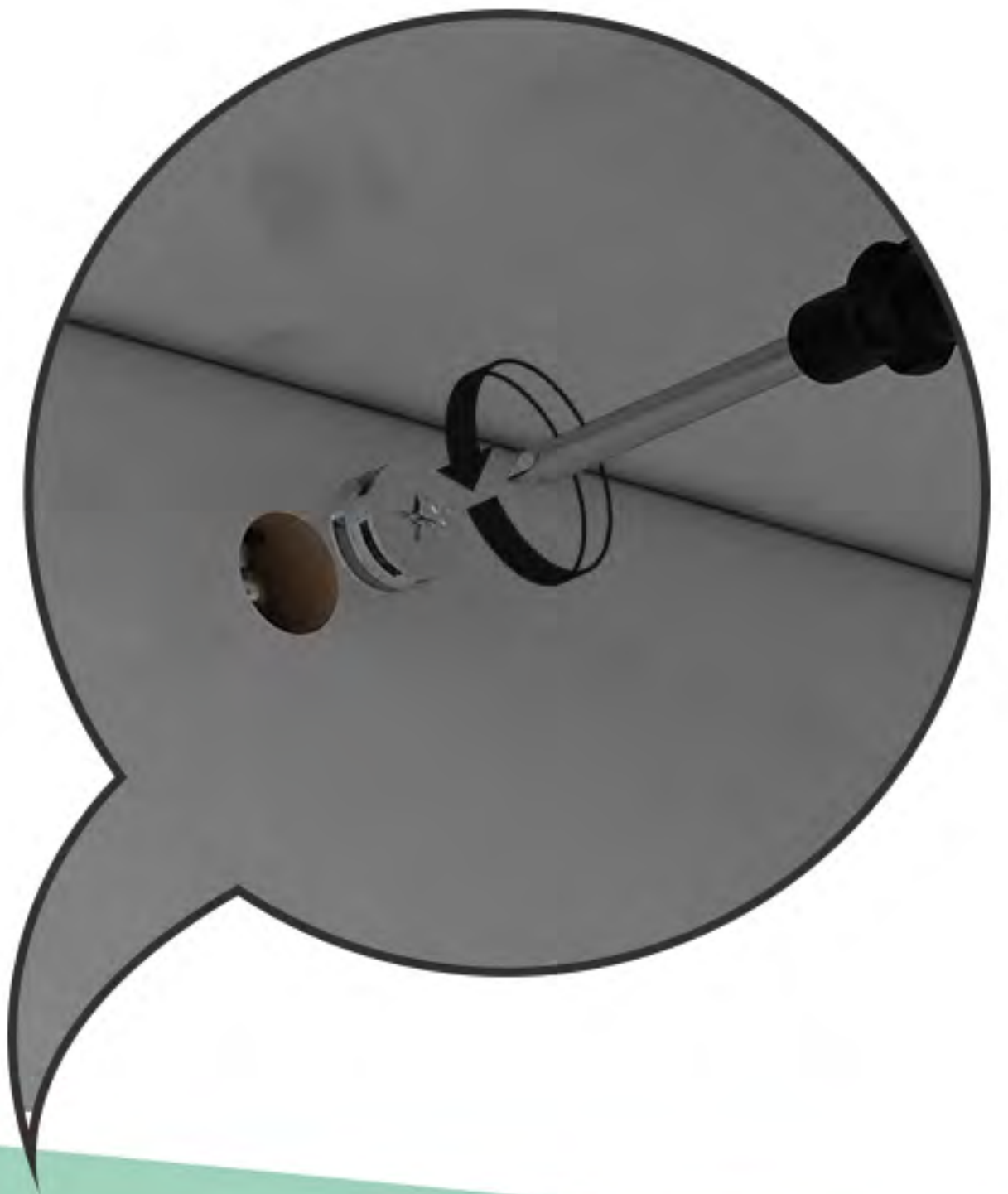
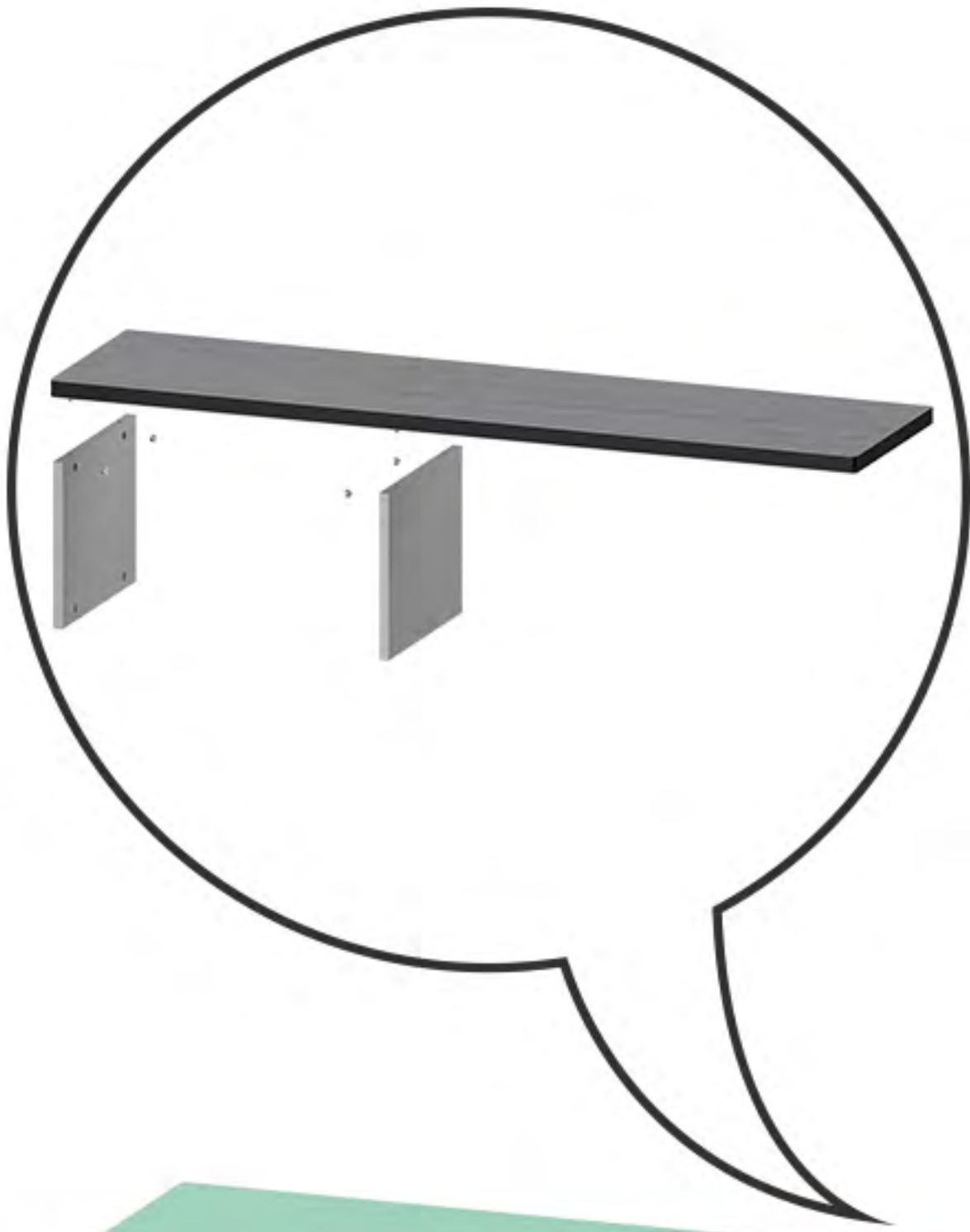

14

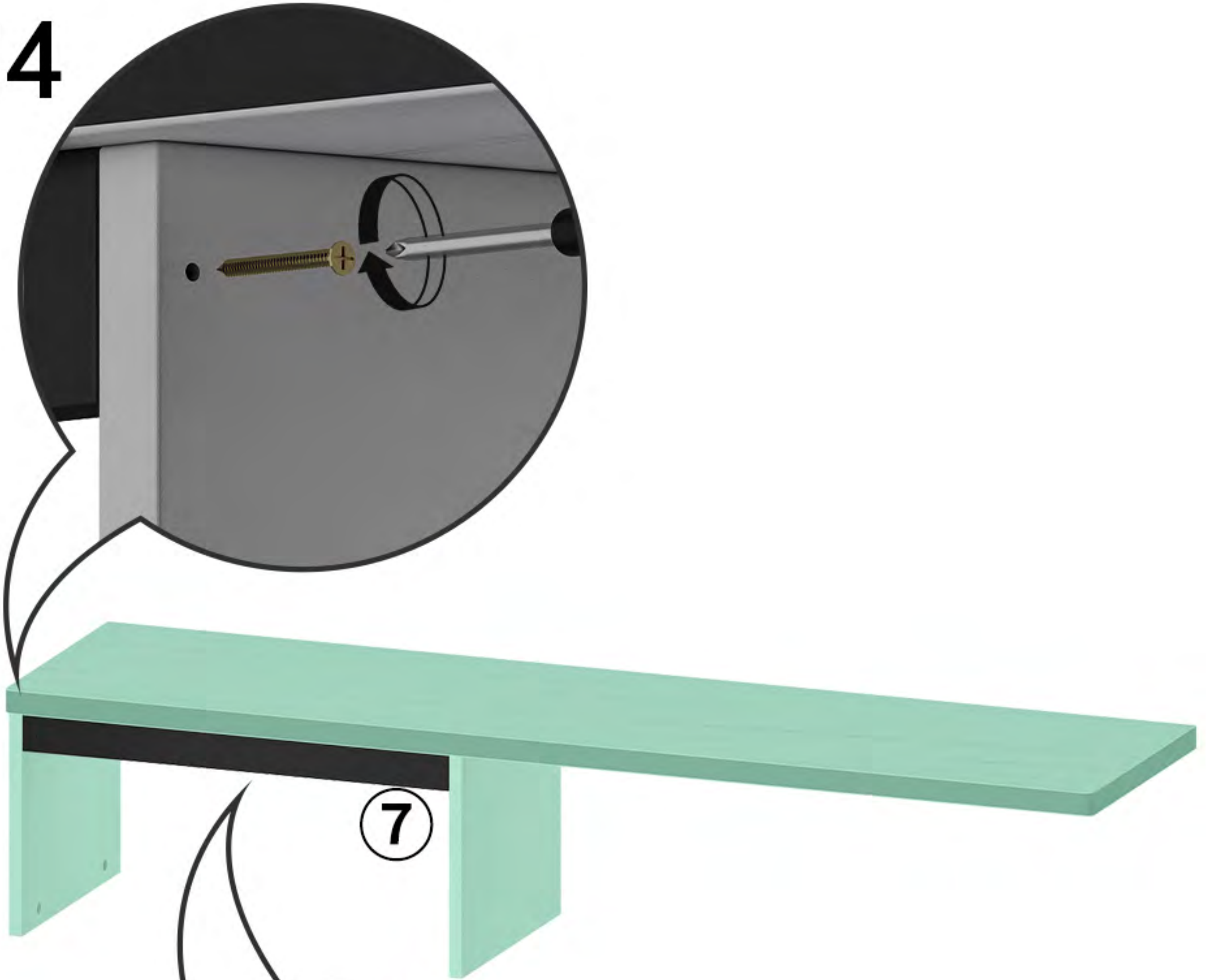

15

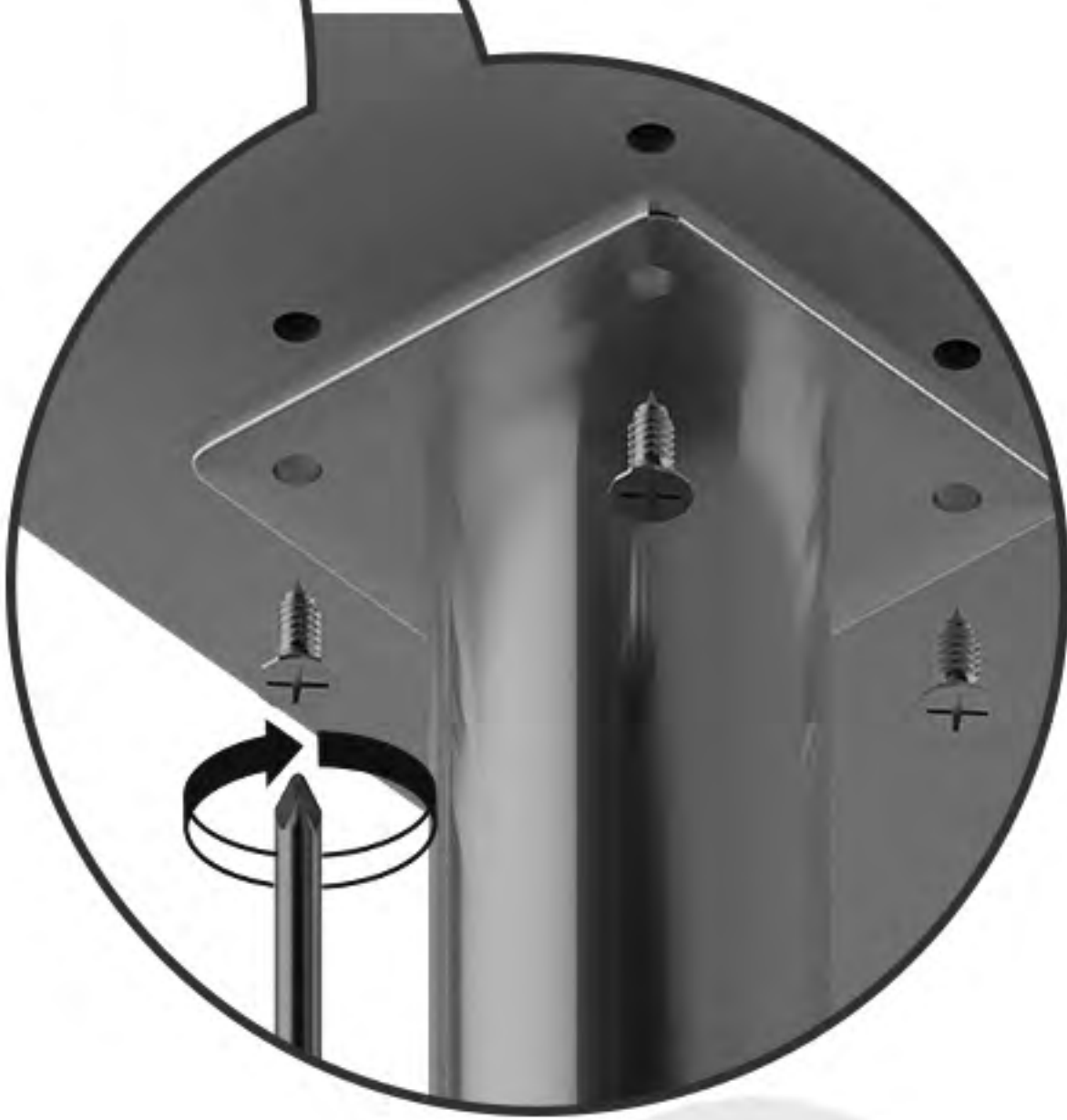
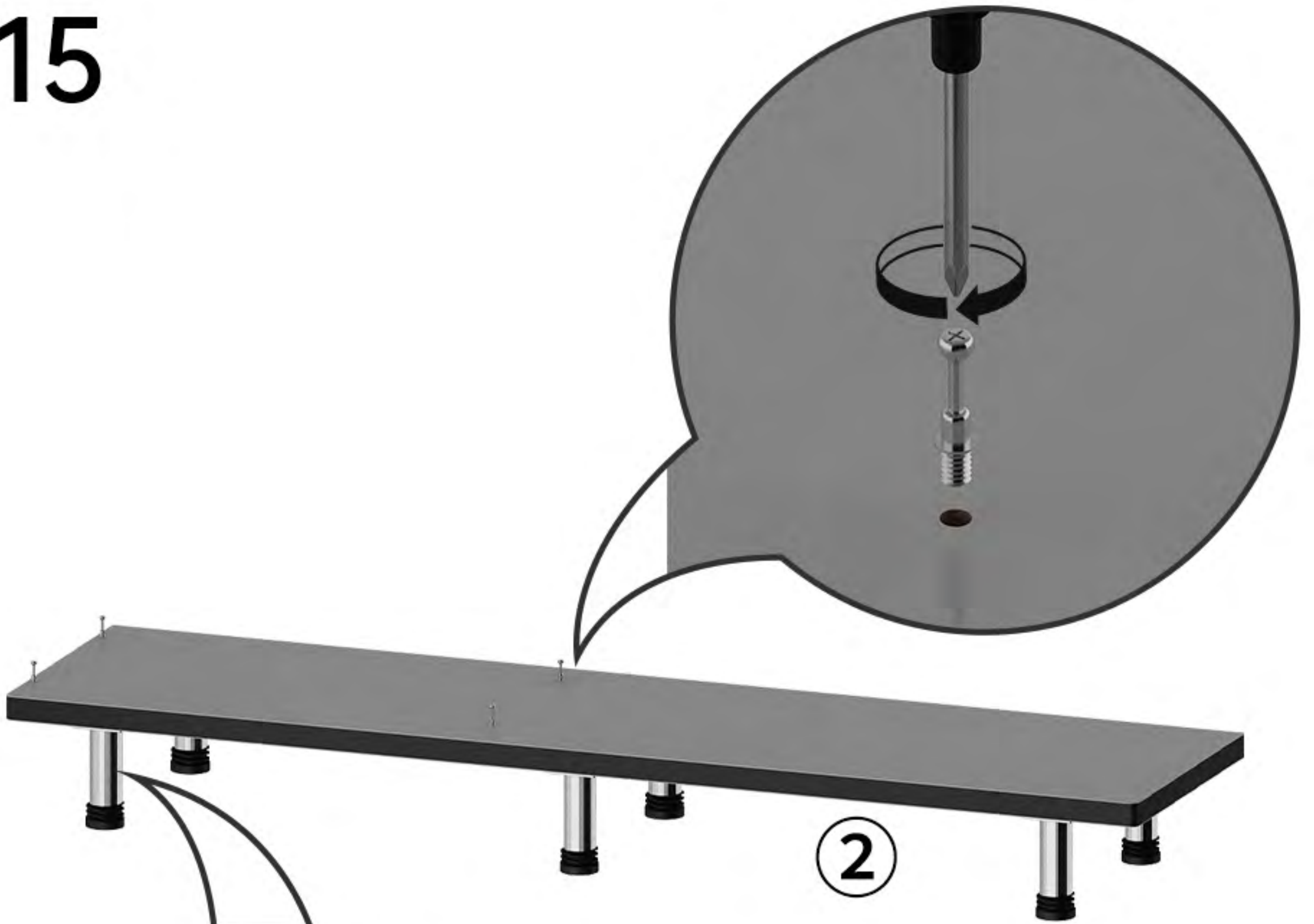

D0



2



L55



A1

16

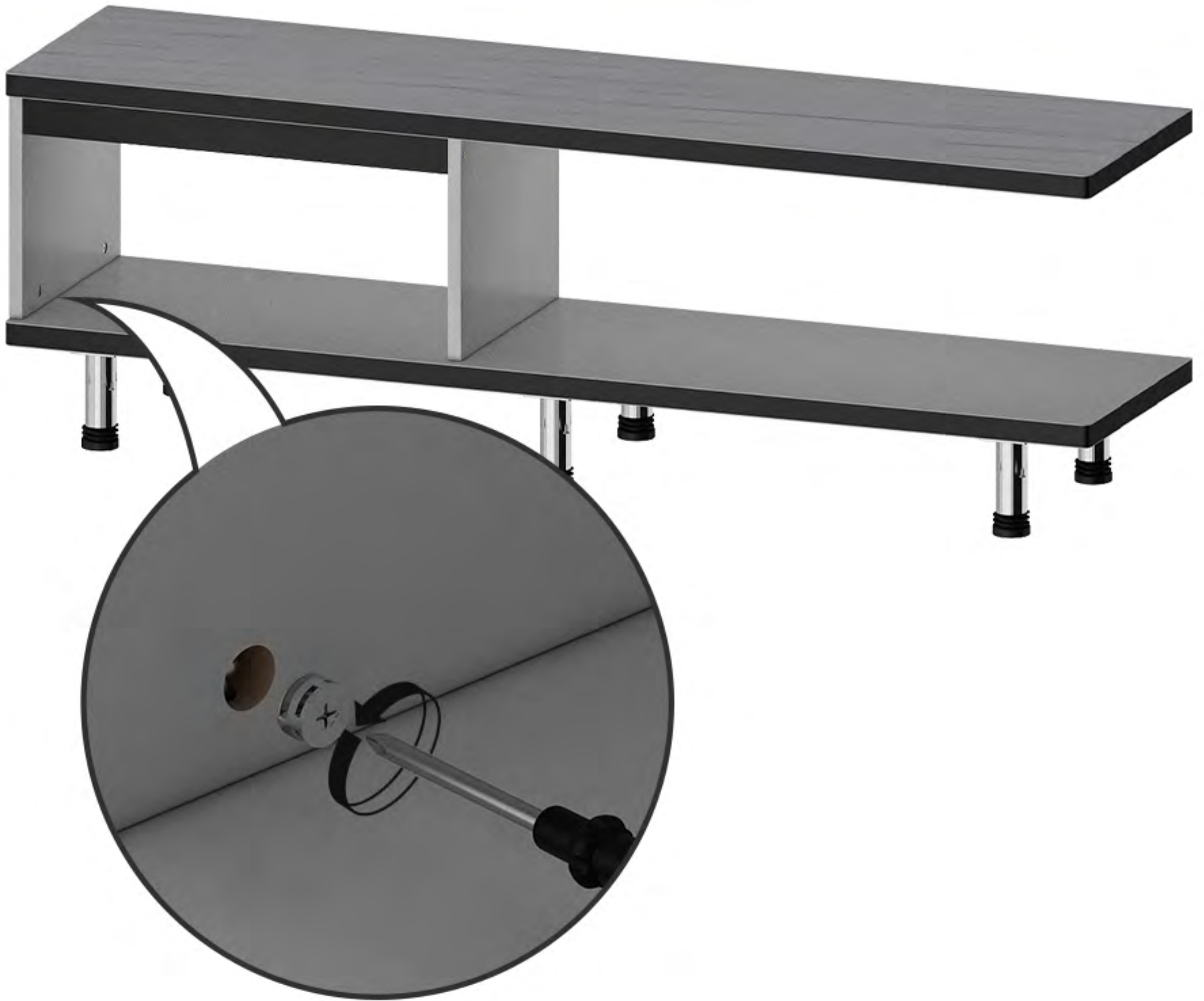

17

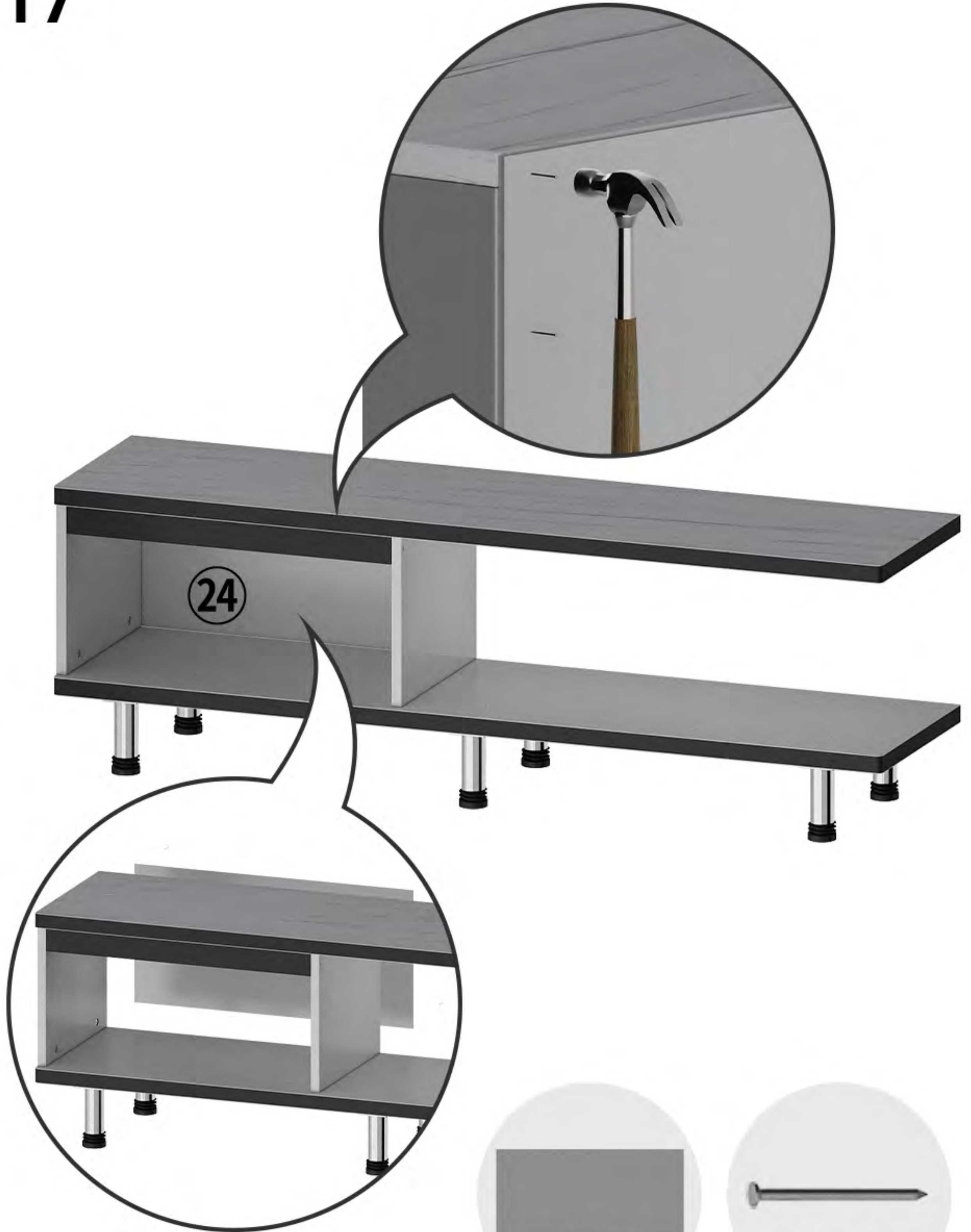

18



19

