

Furniture
Installation



Shoe rack installation

GAR002-6T





E2*9



E5*50



B4*7



K8*4



H2*50



Q23*4



S6*4



N19*4



E7*12



Screwdriver



①

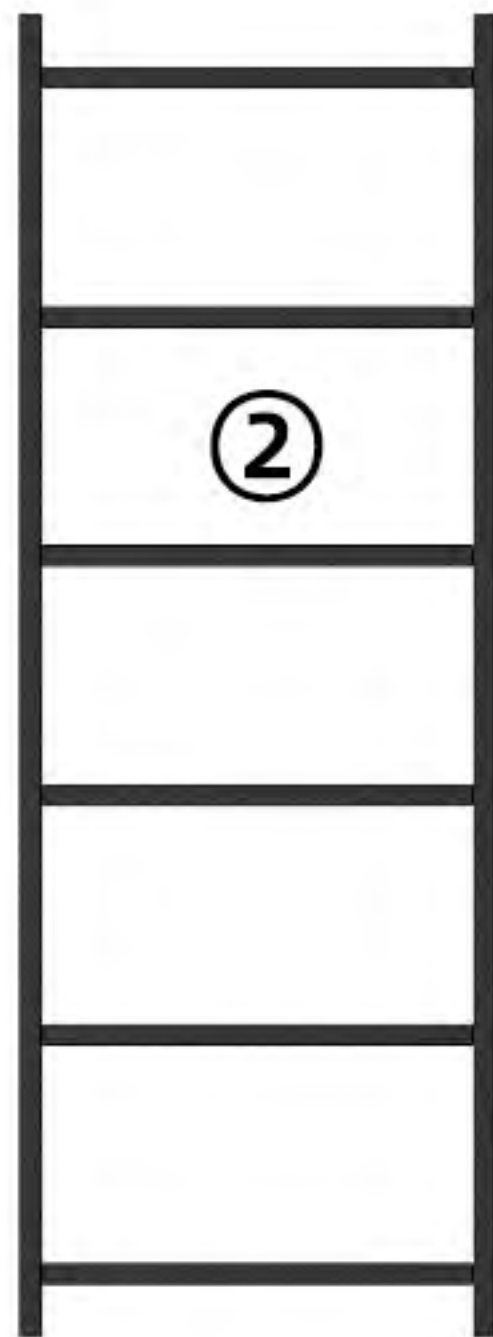

②



③



④



⑤

1

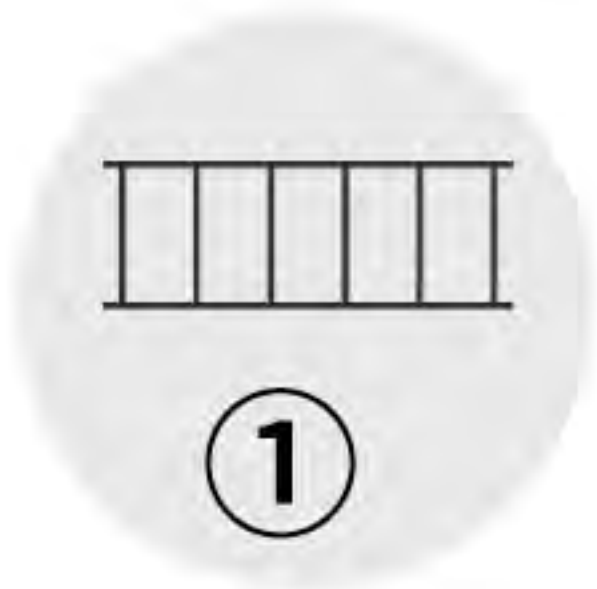
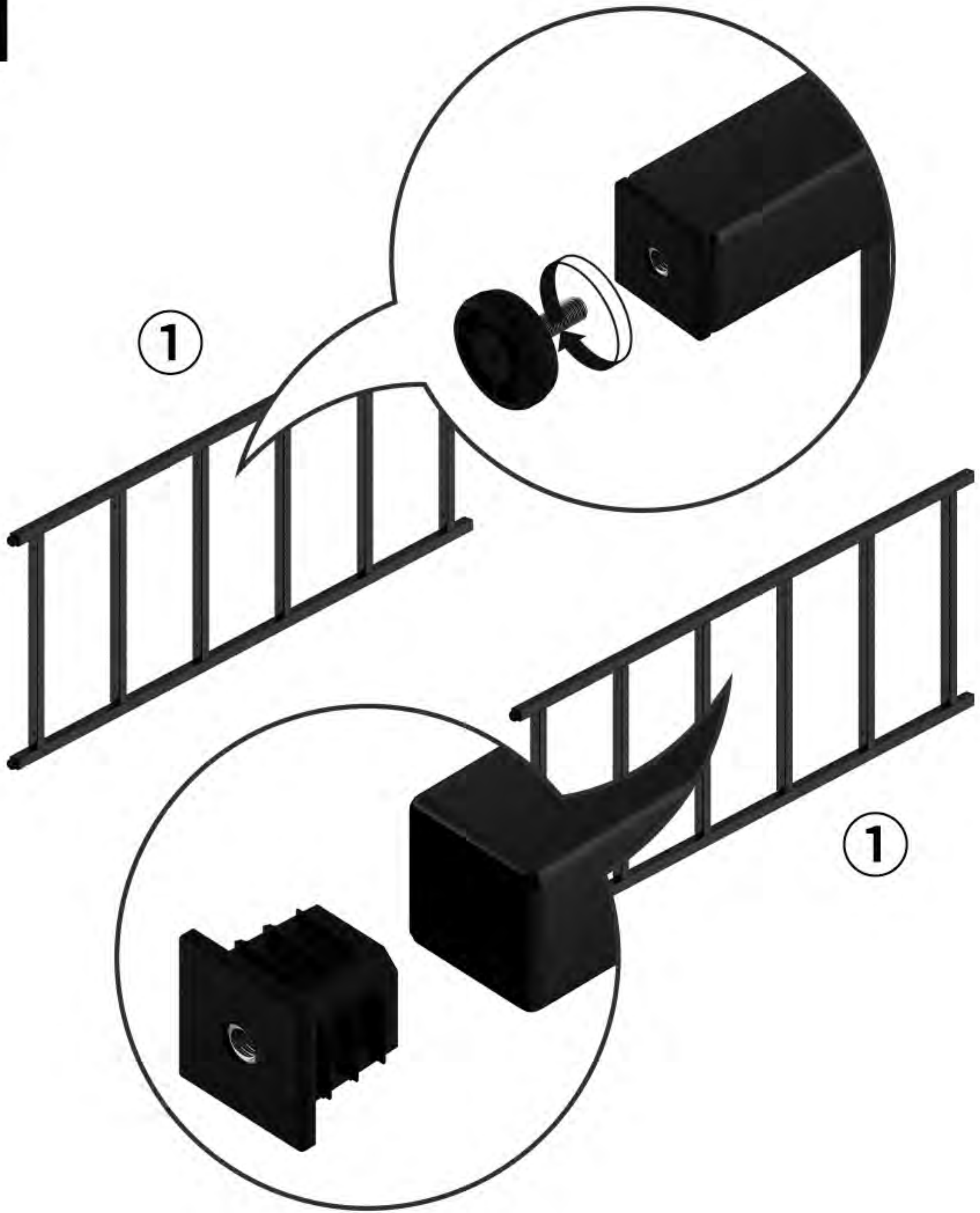

2

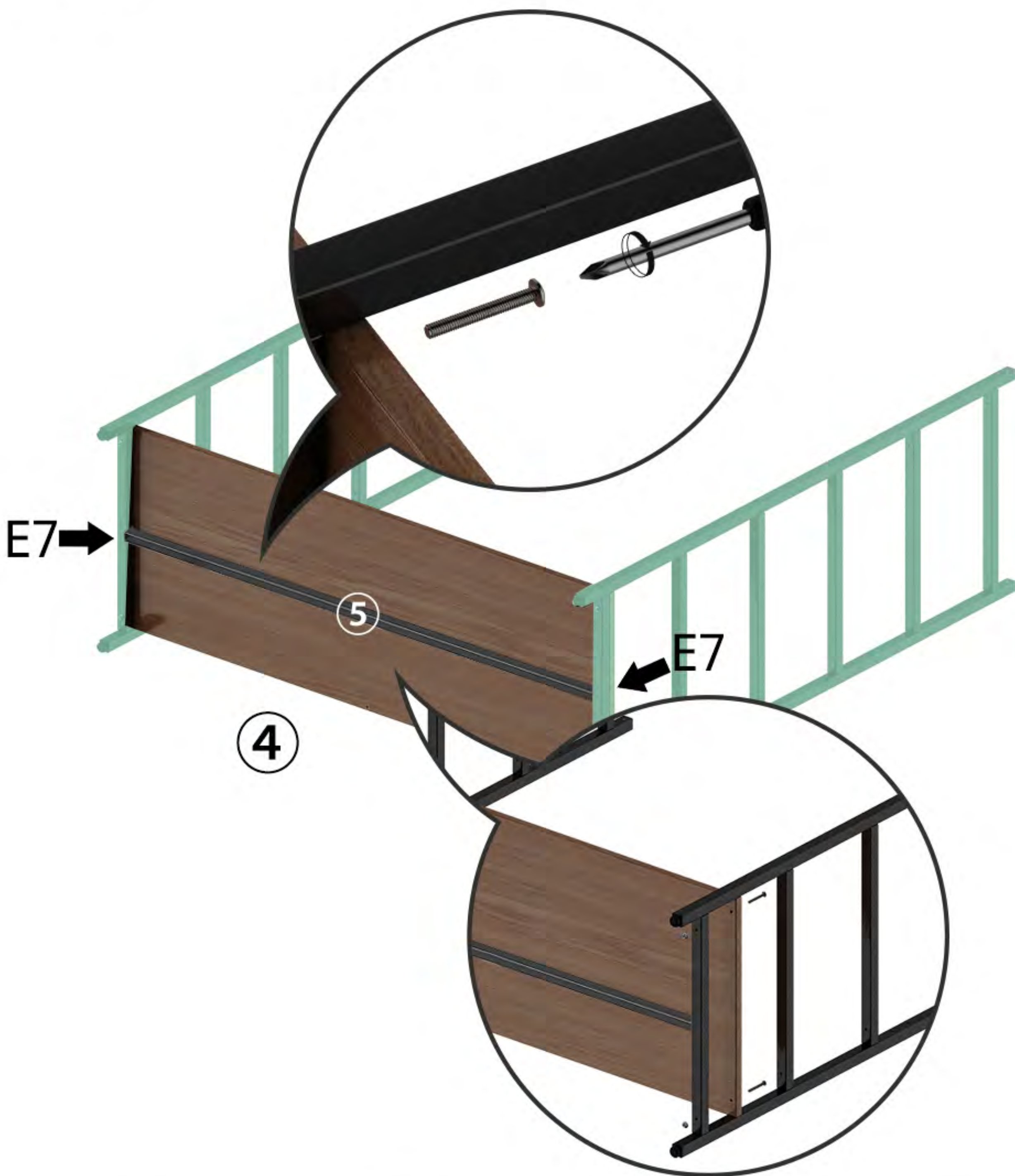

3

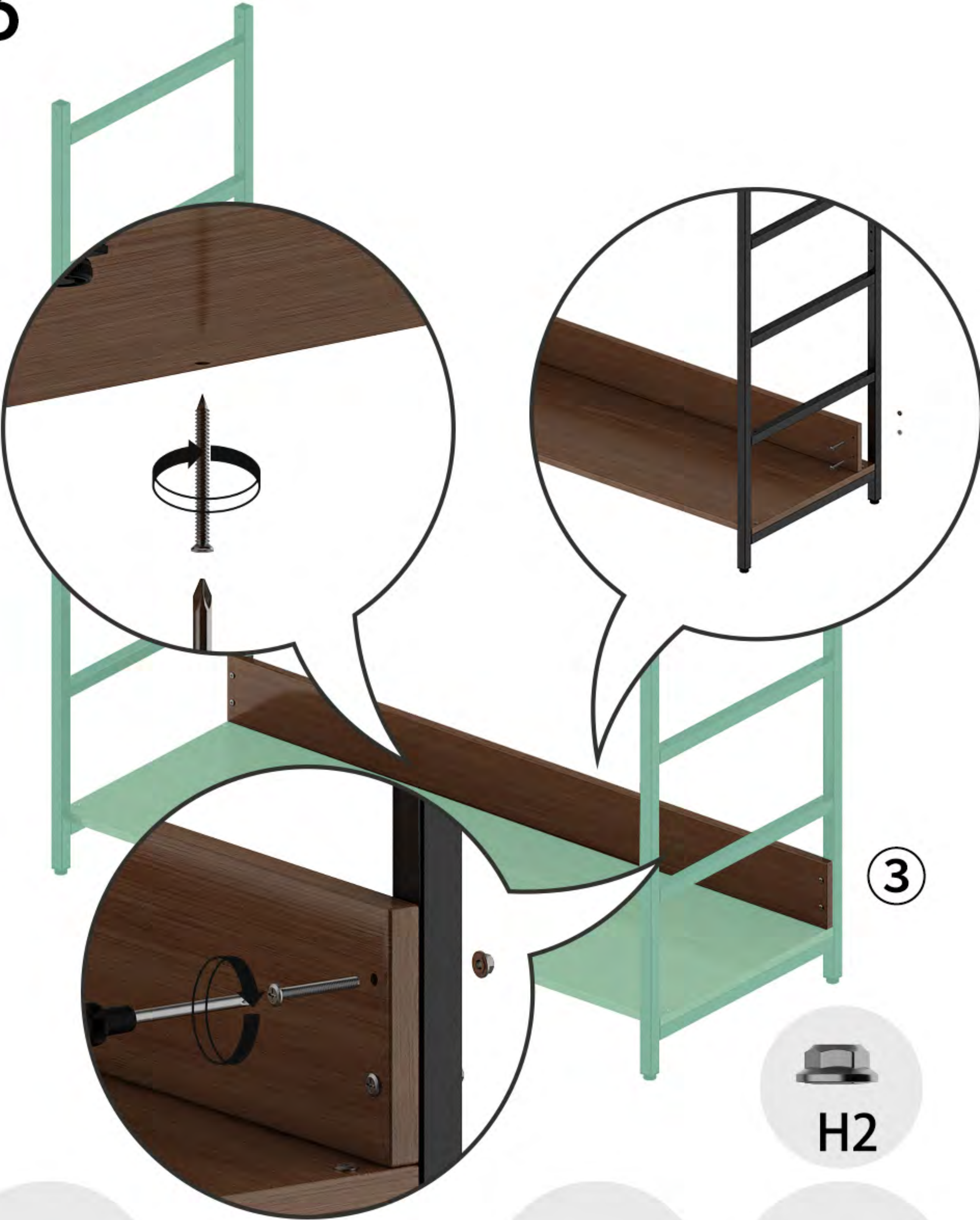

3



E5

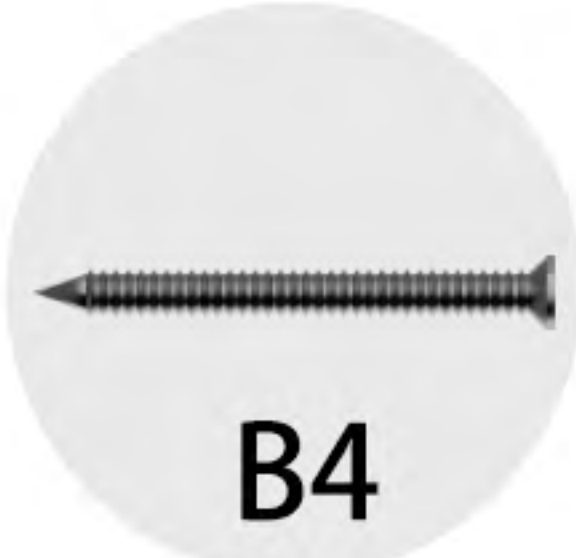

B4



H2

3

4

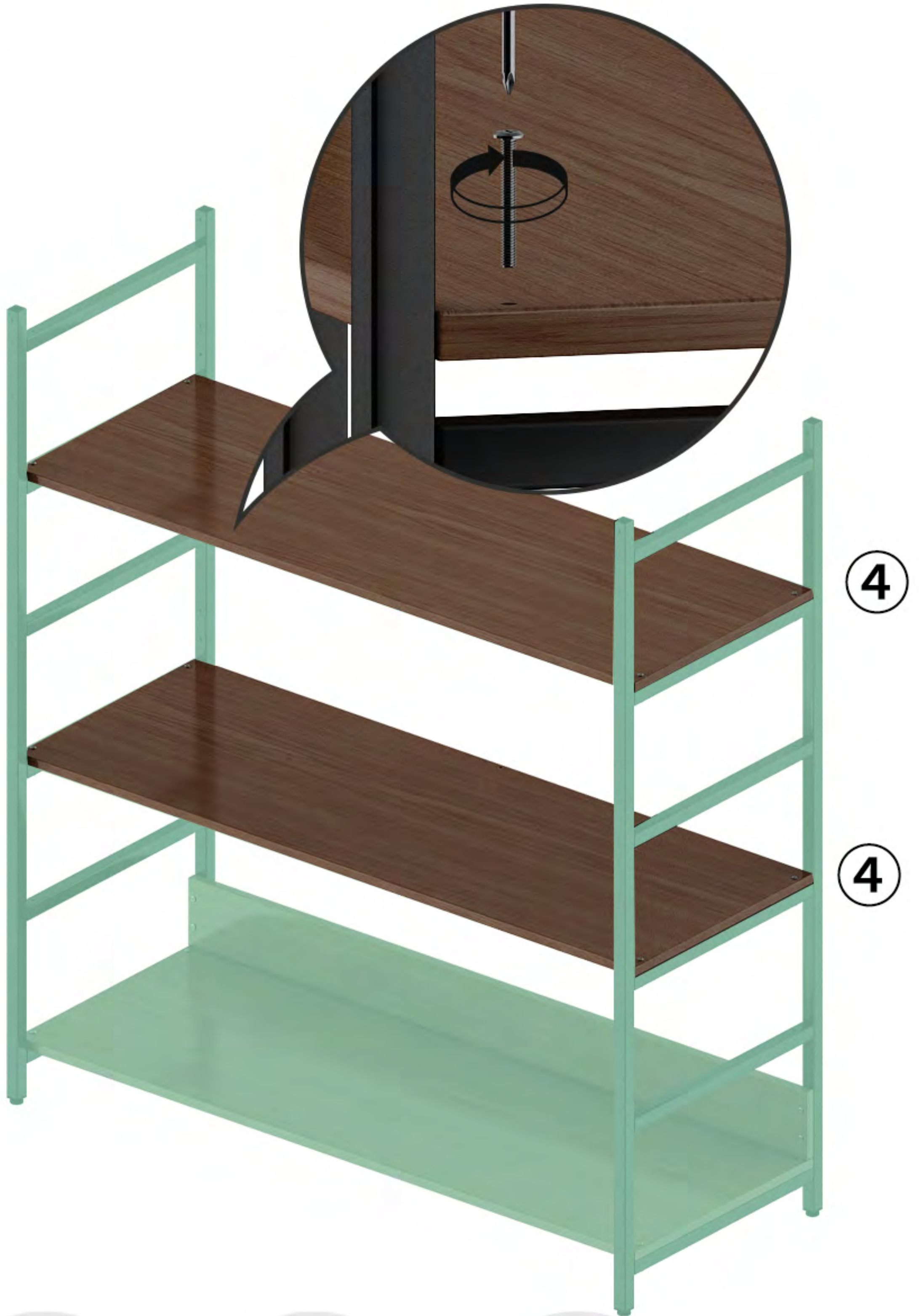

5

Repeat once to get the
above part

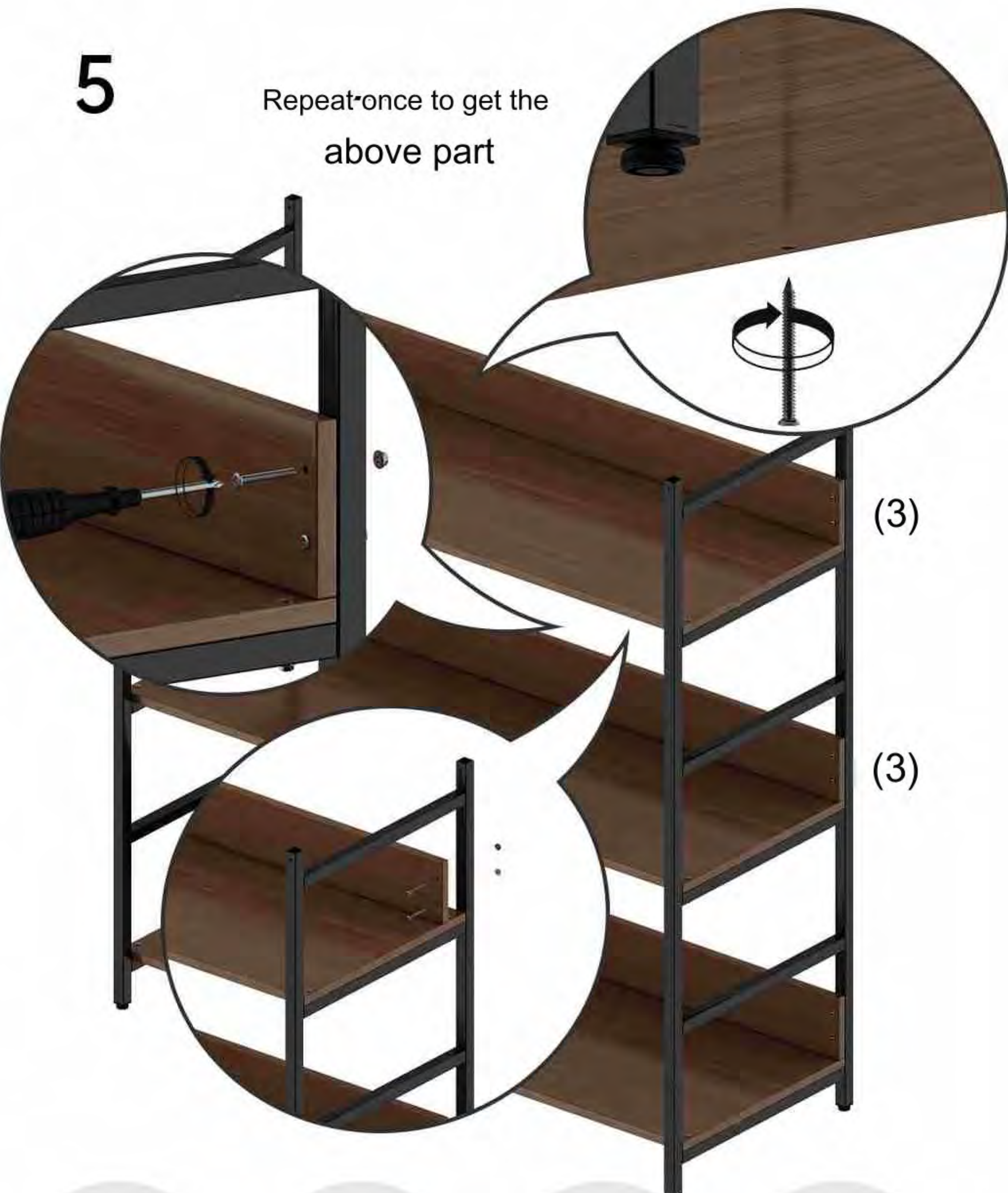

6



S6



E2

7



E2

8

